

Inch

Wrap-Around Locking Cotter Pins

Pouce

Goupilles aux fermetures enroulantes

RUE™ RING COTTERS PATENT NO. 4,592,689

REVOLUTIONARY WRAP-AROUND LOCKING COTTER

REUSABLE - WON'T COME OFF
DOUBLE LOCKING MECHANISM TENSIONS PARTS TIGHT

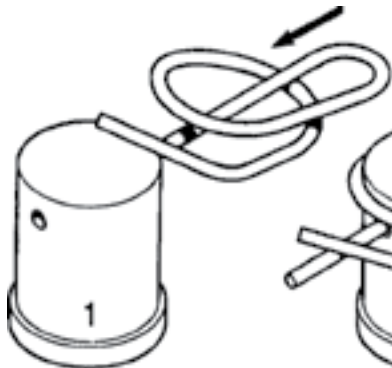

TO INSTALL
PUSH ON - CAM RAMP
LIFTS RING OVER PIN

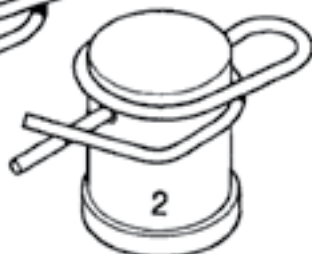

AUTOMATIC LOCK
RING CAPTURES
PIN



TO REMOVE
PUSH UP AND BACK
ON CAM RAMP

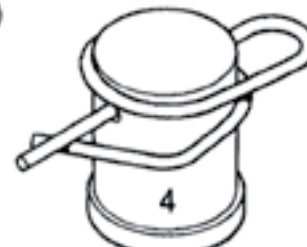

OPTIONAL MANUAL LOCK
TENSIONS JOINT

Available in - **MB HARD DRAWN SPRING WIRE - Zinc Plated**
and **STAINLESS STEEL - Type 302**

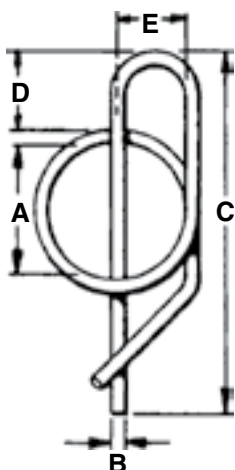

SPAENAUR No.		FITS SHAFT SIZE	Dimensions in Inches					PKG QTY.
HARD DRAWN SPRING WIRE	STAINLESS STEEL 302		A	B	C	D	E	
090-200	090-800	1/4"	.257-.267	.041	.844	.2500	.1250	100
090-201		1/4"	.260-.270	.054	.936	.2810	.1250	100
090-202		5/16"	.320-.330	.047	1.044	.3125	.1563	100
090-203	090-801	3/8"	.382-.392	.054	1.214	.3440	.1875	100
090-204		1/2"	.510-.520	.062	1.420	.3750	.2500	100
090-205	090-802	1/2"	.510-.520	.072	1.456	.3750	.2500	100
090-206		5/8"	.635-.645	.072	1.690	.4375	.3125	100
090-207		3/4"	.760-.770	.080	2.081	.5000	.3750	100
090-208		3/4"	.760-.770	.091	2.166	.5000	.3750	100
090-209		7/8"	.885-.895	.105	2.506	.5625	.4375	100
090-210		1"	1.010-1.020	.105	2.756	.6250	.5000	100

ILLUSTRATION - SIDE VIEW

Total width of any Rue Ring equals 3 of its wire diameters. The straight wire shaft which goes through the pin hole is one, plus two additional wire loops, one on each side, front and back as illustrated.

Rue Ring Cotters will retro-fit most applications without design changes.

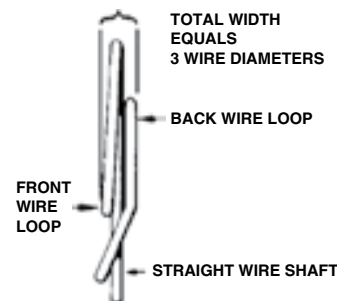

HOLE PLACEMENT - END SHAFT USE ONLY

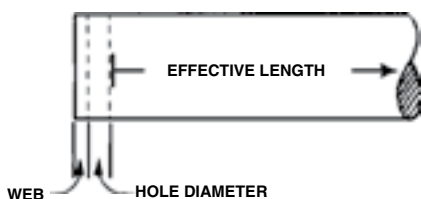

Recommended hole size is 2 times the wire diameter of the selected Rue Ring. This leaves the Rue Ring short of interfering with effective shaft length.

Recommended web thickness is a minimum of 1 wire diameter and a maximum of 2 wire diameters. A thicker web results in more holding power, but makes installation and removal more difficult.