

T-Slot Nuts / Flange Nuts

Inch

Écrous rectangulaires en T / Écrous à embase

Pouce

Tool Room Necessities
Nécessités pour la
place aux outils

T-SLOT NUTS

Hardened Steel
Black Oxide Finish

Inch
Sizes

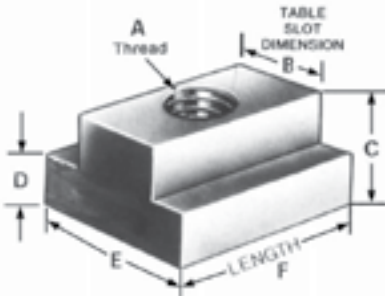

Made to fit all standard machine tables. An imperfect thread is left in the T-Nut base to eliminate any danger of screwing the stud through the T-Nut and damaging the table slot. Also, hardened machine surfaces will not damage underside of T-slot.

PKG QTY. 1

T-SLOT NUTS and RITE HITE Clamps
Use them with
T SLOT BOLTS
see page B297.

SPAENAUR No.	A THREAD	B SLOT	C	D	E	F LENGTH
226-319	1/4-20	5/16	1/4	3/16	9/16	9/16
226-320	1/4-20	3/8	3/8	15/64	9/16	9/16
226-009	5/16-18	3/8	1/2	3/16	5/8	7/8
226-321	5/16-18	3/8	3/8	1/4	5/8	7/8
226-310	3/8-16	7/16	1/2	7/32	11/16	7/8
226-311	3/8-16	1/2	1/2	9/32	7/8	7/8
226-322	3/8-16	9/16	5/8	11/32	7/8	1-1/8
226-324	7/16-14	1/2	3/8	7/32	3/4	7/8
226-312	1/2-13	9/16	5/8	11/32	7/8	1-1/8
226-313	1/2-13	5/8	5/8	11/32	1	1-1/8
226-325	1/2-13	5/8	3/4	3/8	1-1/8	1-1/8
226-326	1/2-13	11/16	3/4	7/16	1-1/8	1-1/4
226-314	5/8-11	11/16	3/4	7/16	1-1/8	1-1/4
226-315	5/8-11	3/4	3/4	15/32	1-1/4	1-1/4
226-328	5/8-11	13/16	1	9/16	1-1/4	1-1/2
226-316	3/4-10	13/16	1	9/16	1-1/4	1-1/2
226-317	3/4-10	7/8	1	9/16	1-1/2	1-1/2
226-318	3/4-10	1	1	5/8	1-5/8	1-3/4
226-G25-1W	3/4-10	1	1-1/3	3/4	1-3/4	1-3/4
226-330	3/4-10	1-1/16	1-1/8	11/16	1-5/8	2
226-331	7/8-9	1	1	5/8	1-5/8	1-3/4
226-332	7/8-9	1-1/16	1-1/8	11/16	1-5/8	2
226-333	7/8-9	1-1/8	1-1/2	3/4	1-3/4	2
226-337	7/8-9	1-5/16	1-1/4	15/16	2	2
226-334	1-8	1-1/16	1-1/8	11/16	1-5/8	2
226-335	1-8	1-1/8	1-1/2	3/4	1-3/4	2
226-336	1-8	1-1/4	1-1/4	7/8	2	2
226-338	1-8	1-5/16	1-1/4	15/16	2	2

FLANGE NUTS

Inch Sizes



Hardened Steel
Black Oxide
Finish

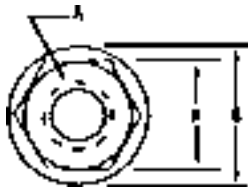

PKG QTY. 6

SPAENAUR No.	A THREAD	B O/A Dia.	C O/A Thick.	K Across Flats
155-230	1/4"-20	5/8	5/16	1/2
155-231	5/16"-18	3/4	3/8	9/16
155-232	3/8"-16	7/8	1/2	11/16
155-241	7/16"-14	1	9/16	3/4
155-234	1/2"-13	1-1/8	11/16	7/8
155-235	5/8"-11	1-3/8	13/16	1-1/16
155-236	3/4"-10	1-5/8	1	1-1/4
155-237	7/8"-9	1-3/4	1-1/8	1-7/16
155-238	1"-8	2	1-1/4	1-5/8
155-240	1-1/4"-7	2-1/4	1-1/4	1-7/8

More Flange Nuts - see pages
C36 to C38, & B299.

T-Slot Bolts / T-Slot Nuts

Boulons en T / Écrous rectangulaires en T



Metric

Métrique

B

METRIC
T-Slot Bolts

Used for setting up work on planers, shapers, milling machines or similar applications. Forged, with milled T-slot guide-faces, rolled thread.

Tool Room Necessities
Nécessités pour la place aux outils

(M6-M12 heat-treated to strength class 10.9, M14-M42 to class 8.8)

Black Oxide Finish



DIN 787

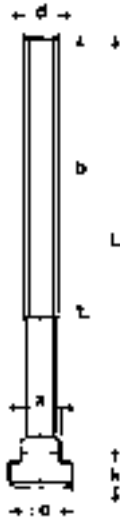

SPAENAUR No.	All Dimensions Stated in Millimetres					PKG QTY.
	Thread Dia. x a (nom.) x L	b	a	e	k	
070-100	M6 x 6 x 25	15	5.7	10	4	1
070-101	M6 x 6 x 40	28	5.7	10	4	1
070-102	M8 x 8 x 32	22	7.7	13	6	1
070-103	M8 x 8 x 50	35	7.7	13	6	1
070-104	M10 x 10 x 40	30	9.7	15	6	1
070-105	M12 x 12 x 50	35	11.7	18	7	1
070-106	M12 x 12 x 80	55	11.7	18	7	1
070-107	M12 x 14 x 50	35	13.7	22	8	1
070-108	M12 x 14 x 80	55	13.7	22	8	1
*070-109	M14 x 16 x 63	45	15.7	25	9	1
*070-110	M14 x 16 x 100	65	15.7	25	9	1
070-111	M16 x 18 x 80	55	17.7	28	10	1
070-112	M16 x 18 x 160	100	17.7	28	10	1
*070-113	M20 x 20 x 160	110	19.7	32	12	1
*070-114	M20 x 22 x 160	110	21.7	35	14	1
*070-115	M24 x 24 x 200	125	23.7	40	16	1
070-116	M24 x 28 x 250	150	27.7	44	18	1

*Sizes not included in DIN Standard

DIN 508

METRIC
T-Slot Nuts

Tempered to tensile strength class 10.
The max. load capacity is allowed with the total thread reach of the nut.

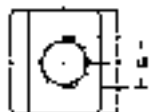

SPAENAUR No.	All Dimensions Stated in Millimetres					PKG QTY.
	Thread Dia. x a (nom.)	a	e	h	k	
226-400	M6 x 8	7.7	13	10	6	1
226-401	M8 x 10	9.7	15	12	6	1
226-402	M10 x 12	11.7	18	14	7	1
226-403	M12 x 14	13.7	22	16	8	1
226-404	M14 x 16	15.7	25	18	9	1
226-405	M16 x 18	17.7	28	20	10	1
226-406	M20 x 22	21.7	35	28	14	1
226-407	M24 x 28	27.7	44	36	18	1
226-408	M30 x 36	35.6	54	44	22	1

B300