

Rivet Nuts

Metric

Écrous-rivets

Métrique

FLAT HEAD

Keyless

Installs like a blind rivet.
When set—it's a riveted-in Nut!



STEEL

Zinc Dichromate Plated

(open-end type)

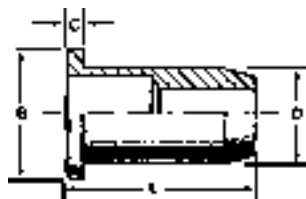

TYPICAL INSTALLATION

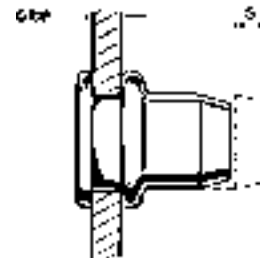

ALL ITEMS ON THIS PAGE
PKG QTY. 100

Metric Threads

SPAENAUR No.	All Dimensions in millimetres							Install Drill Size
	Thread Size	Grip Range	L	B	C	D	S	
194-018	M3	1.50-3.00	10.0	7.5	1.0	5	1.3/2.5	5.1
*194-G01-2M	M4	1.00/2.00	10.5	9.0	1.0	6	1.7/3.8	6.1
194-G06-1C	M4	2.00/4.00	12.0	9.0	1.0	6		
194-019	M5	0.50/3.00	14.0	10.0	1.0	7	2.5/5.0	7.1
194-025	M5	0.50/3.00	20.0	10.0	1.0	7		
*194-009ZP	M6	0.50/3.00	16.0	13.0	1.5	9	22/4.7	9.1
194-022	M6	0.50/3.00	16.0	13.0	1.5	9		
194-024	M6	5.50/8.00	22.0	13.0	1.5	9		

*Zinc Plated

Typical APPLICATIONS

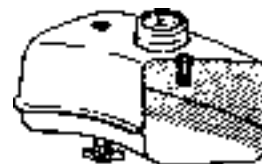

Closed-end Rivet Nuts make liquid-tight seal when installed in tank.
Special Advantages: Sturdy, multiple-thread nut plate.

APPLIANCE LEVELING FEET

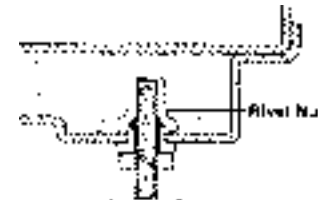

Rivet Nuts provide nut plate for screw that adjusts feet.
Special Advantages: Rivet Nuts puts nut plate in metal too thin to tap.



FLAT HEAD

Keyless

STEEL

Zinc Dichromate Plated

(closed-end type)

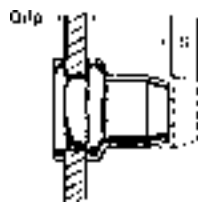
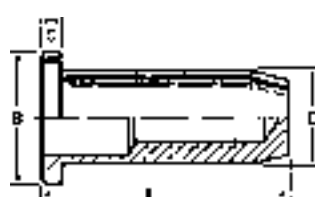

TYPICAL INSTALLATION

SPAENAUR No.	All Dimensions in millimetres							Install Drill Size
	Thread Size	Grip Range	L	B	C	D	S	
194-102	M4	0.25-1.00	14.2	9.0	1.0	6	1.7/3.8	6.1
194-G07-1N	M4	1.00-2.00	15.5	9.0	1.0	6		
194-G08-1T	M4	2.00-4.00	17.0	9.0	1.0	6		
194-G09-1K	M8	0.50-3.00	26.0	16	1.5	11	3.0/5.8	11.1
194-G10-1T	M10	1.50-3.00	32.3	19	2.0	13		

Note:

Metric Rivet Nut sizes not listed on pages C205, & C206 can usually be furnished in minimum lots upon request.

For more Rivet Nuts see pages C140 - C141

Metric

Métrique

Rivet Nuts

Écrous-rivets



FLAT HEAD

(open-end type)

ALUMINUM Plain

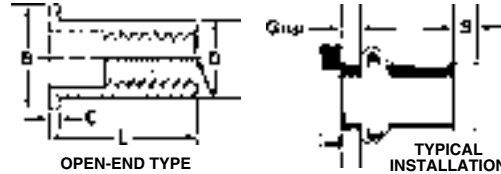

Metric

Rivet Nut

APPLICATIONS

SPAENAUR No.	All dimensions in millimetres							Install Drill Size
	Thread Size	Grip Range	L	B	C	D	S	
195-H07-1M	M3	0.25-1.00	8.2	7.5	1.0	5	1.0/1.7	5.1
195-002	M3	1.00-1.75	9.0	7.5	1.0	5		
195-004	M3	2.50-3.25	10.6	7.5	1.0	5		
195-005	M3	3.25-4.00	11.4	7.5	1.0	5		
195-006	M4	0.25-1.00	9.9	9	1.0	6	1.3/2.0	6.1
195-007	M4	1.00-1.75	10.6	9	1.0	6		
195-H06-1W	M4	2.50-3.25	12.1	9	1.0	6		
195-015	M5	3.00-4.00	14.7	10	1.0	7	1.5/3.0	7.1
195-016	M5	4.00-5.00	15.8	10	1.0	7		
195-H03-1N	M6	3.00-4.50	18.2	13	1.5	9	1.8/3.3	9.1
195-021	M6	4.50-6.00	19.8	13	1.5	9		
195-219	M8	0.50-3.00	20.0	16	1.5	11	3.0/4.5	11.1
195-H05-1K	M8	3.00-4.50	21.6	16	1.5	11		
195-027	M10	0.70-1.50	22.8	19	2.0	13	3.0/4.5	13.1
195-029	M10	3.00-4.50	26.0	19	2.0	13		
195-030	M10	6.00-7.50	29.2	19	2.0	13		
195-031	M10	9.00-10.50	32.4	19	2.0	13		
195-032	M12	1.50-3.00	27.8	23	2.0	16	3.0/4.5	16.15
195-033	M14	3.00-4.50	33.9	24	2.5	18		
195-034	M16	3.00-4.50	37.3	28	2.5	21		



BARBEQUE CART
Flat panels fastened securely to tubular legs with Rivet Nuts.
Special Advantages: Blind side fastening; fast installation.



AIR CONDITIONER FASTENING
Rivet Nuts under bottom panel permits wing nut attachment.
Special Advantages: Easy accessibility to fan and controls.

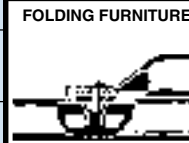

FOLDING FURNITURE
Pivot points in tubular furniture are natural spots for Rivet Nuts.
Special Advantages: Improved appearance; fast installation.



APPLIANCE DOORS
Rivet Nuts solve blind fastening and nut-plate problems on appliances.
Special Advantages: Rivet Nuts can be installed after assembly.



OIL RESERVOIR COVERS
Rivet Nuts with closed ends extend into reservoirs, act as nut plates.
Special Advantages: No tapping of holes, no welding or grinding.



BOAT STEP PADS
Rivet Nuts in coaming permits easy mounting and replacement.
Special Advantages: Installation from the interior; neater design.

FLAT HEAD

(Closed end type)

ALUMINUM Plain

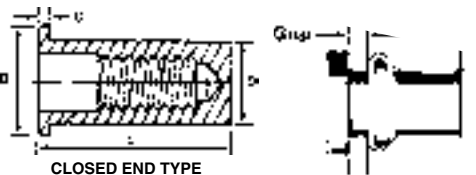

SPAENAUR No.	All dimensions in millimetres							Install Drill Size
	Thread Size	Grip Range	L	B	C	D	S	
195-H04-1T	M4	0.05-3.00	16.0	9.0	1.0	6	1.3/2.0	6.1
195-H01-1Y	M6	3.00-5.50	25.2	13	1.5	9	1.8/3.3	9.1

**PKG QTY. 100
ALL ITEMS ON THIS PAGE**

For more Rivet Nuts see pages C140 - C141

Rivet Nuts

Metric

Écrous-rivets

Métrique

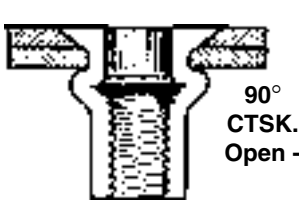

90° CTSK. Open -



**Installs like a blind rivet.
When set - it's a riveted-in Nut!**



90° CTSK. Closed - Keyless

COUNTERSUNK HEAD

ALL ITEMS ON THIS PAGE
PKG QTY. 100

Open-end type

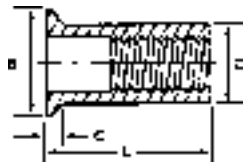

OPEN-END TYPE



Countersunk Head

ALUMINUM Plain

All Dimensions in millimetres

SPAENAUR No.	Thread Size	Grip Range	L	B	C	D	S	Install Drill Size
195-200	M3	1.30-1.75	8.4	7.2	1.4	5	1.0/1.7	5.1
195-203	M4	1.30-1.75	9.5	8.2	1.4	6	1.3/2.0	6.1
195-204	M4	1.75-2.50	10.5	8.2	1.4	6	1.3/2.0	6.1
195-218	M5	1.50-4.50	14.2	9.6	1.6	7	1.5/3.0	7.1
195-212	M6	4.50-6.00	18.0	11.7	1.6	9	1.8/3.3	9.1
195-213	M6	6.00-7.50	19.8	11.7	1.6	9	1.8/3.3	9.1
195-217	M8	1.50-4.50	18.6	13.3	1.6	11	3.0/4.5	11.1
195-215	M10	3.00-4.50	24.0	15.5	1.6	13	3.0/4.5	13.1
195-216	M12	3.00-4.50	27.4	19.0	1.8	16	3.0/4.5	16.15

STEEL Zinc Dichromate Plated

194-200	M3	1.25-1.75	8.8	7.2	1.4	5	1.3/2.5	5.1
194-201	M4	2.00-3.00	10.5	8.2	1.4	6	1.7/3.8	6.1
194-G03-1A	M5	2.00-4.00	12.7	9.6	1.6	7	2.5/5.0	7.1
194-020	M8	1.50-4.00	17.8	13.1	1.6	11	3.0/5.5	11.1

Closed-end type

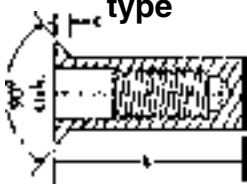

CLOSED-END TYPE



TYPICAL INSTALLATION

ALUMINUM Plain

SPAENAUR No.	Thread Size	Grip Range	L	B	C	D	S	Install Drill Size
195-300	M4	1.75-2.50	15.5	8.2	1.4	6	1.3/2.0	6.1
195-H02-1C	M6	3.00-4.50	23.6	11.7	1.6	9	1.8/3.3	9.1

STEEL Zinc Dichromate Plated • Clear Zinc

194-300	M4	1.25-1.75	14.2	8.2	1.4	6	1.7/3.8	6.1
194-G04-1P	M4	1.75-2.50	15.0	8.2	1.4	6	1.7/3.8	6.1
194-G05-1Y	M4	2.00-3.00	15.5	9.6	1.6	7	2.5/5.0	7.1
194-302	M5	1.50-2.00	17.7	9.6	1.6	7	2.5/5.0	7.1
• 194-G02-1X	M5	2.00-3.00	18.8	9.6	1.6	7	2.5/5.0	7.1
194-021	M6	1.50-4.00	22.9	11.7	1.6	9	2.2/4.7	9.1
194-023	M8	1.50-4.00	25.9	13.5	1.6	11	3.0/5.5	11.1

For more Rivet Nuts see pages C140 - C141