

Hex Flange / Disc-Lock® Nuts

Inch and Metric

Écrous hexagonaux à embase / Disc-Lock®

Pouce et Métrique

HEX FLANGE NUTS

DIN 6923

This Standard has been replaced. Please see Catalog Page R21 for more information.

Metric

Property Class 8 & 10 Steel
Zinc Plated

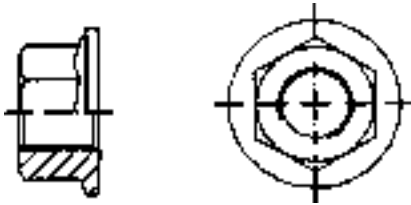

METRIC SIZES — Dimensions in Millimetres

Property Class	Nom. Size	SPAENAUR No.	Pitch mm	Width A/F	Thick-ness	Maximum Flange Dia.	PKG QTY.
8	M5	175-114	0.80	8.00	5	11.8	100
	M6	175-115	1.00	10.0	6	14.2	100
	M8	175-116	1.25	13.0	8	17.9	100
	M10	175-117	1.50	16.0	10	21.8	50
	M12	175-118	1.75	18.0	12	26.0	50
	M14	175-119	2.00	21.0	14	29.9	50
	M16	175-120	2.00	24.0	16	34.5	50
M20	175-121	2.50	30.0	20	42.8	25	
10	M5	175-122	0.80	8.00	5	11.8	100
	M6	175-123	1.00	10.0	6	14.2	100
	M8	175-124	1.25	13.0	8	17.9	100
	M10	175-125	1.50	16.0	10	21.8	50
	M12	175-126	1.75	18.0	12	26.0	50
	M14	175-127	2.00	21.0	14	29.9	50
	M16	175-B09-1M	2.00	24.0	16	34.5	50
M20	175-129	2.50	30.0	20	42.8	25	

HEX NUT

with serrated flange

Tension Locking

Metric

Property Class 8 Steel
Black Finish



METRIC SIZES — Dimensions in Millimetres

Size Dia.	SPAENAUR No.	Pitch mm	Width A/F	Thick-ness	O/A Dia.	PKG QTY.
M5	224-211	0.80	8	4.3	11.2	100
M5	*224-211ZP	0.80	8	4.3	11.2	100
M5	▲224-302	0.80	8	4.3	11.2	100
M6	224-212	1.00	10	5.5	14.25	100
M6	*224-212ZP	1.00	10	5.5	14.25	100
M8	224-213	1.25	13	7	18.25	50
M8	*224-213ZP	1.25	13	7	18.25	50
M10	224-G01-1X	1.50	15	7.9	21	50
M12	224-215	1.75	17	8.7	24	50

▲ Class 10 * Zinc Plated

HEX FLANGE DISC-LOCK® NUTS - Inch Sizes

MEETS PHYSICAL REQUIREMENTS OF ASTM A 194 - 2H MTL: STEEL

MIL TEST MIL- STD 1312
VIBRATION TEST #7

INCH SIZES

Sizes 1/2" - 5/8" Zinc Chromate Plated Steel
3/4" & larger Zinc Plated & Phosphated to MIL - 46010

150,000 PSI & 1040 MPa
PROOF LOAD
HARDNESS RC 24-38

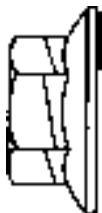

Nominal Size	COARSE THREAD		FINE THREAD		Width A/F (Inches)		Maximum Flange Diameter	Nominal Overall Height	PKG QTY.
	Nominal	SPAENAUR No.	Nominal	SPAENAUR No.	Max.	Min.			
5/8"-11		175-202	1/2"-20	175-201	0.942	0.922	1.281"	0.820"	25
3/4"-10		175-204	5/8"-18	175-203	0.942	0.922	1.281"	0.820"	25
					1.250	1.212	1.732"	0.875"	20