









E-Z LOK® Products Table of Contents

Table des matières des produits E-Z LOK^{MD}

	<p>Carbon Steel Inserts for Metal</p>	<p>Solid Threaded Inserts for Metal <i>Ideal for repairing or reinforcing threaded holes in magnesium, cast iron, aluminum, and other soft metals, E-Z LOK's solid threaded inserts are machined out of solid steel for strength and durability. Our threaded inserts are easy to install, with no special tools needed, and are self-locking thanks to a special pre-applied adhesive. Available in a wide range of inch and metric thread sizes, lengths, and configurations to meet your needs.</i></p>	<p><i>Page No.</i> C184-C185</p>
	<p>Stainless Steel Inserts for Metal</p>		<p>C186</p>
<p>NEW</p> 	<p>Coil Threaded Inserts for Metal</p>	<p>Coil Threaded Inserts <i>Also known as helical inserts, E-Z LOK's coil threaded inserts for metal are available in a variety of standard inch and metric sizes to meet your needs. Made from 18-8 stainless steel, they provide strong internal threads for the quick repair of damage threads in soft metal materials. They can also be used to reinforce tapped holes and prevent thread stripping and wear.</i></p>	<p>C187-C190</p>
<p>NEW</p> 	<p>Coil Insert Thread Repair Kits</p>	<p>Kits <i>We offer coil threaded insert kits for our inch, metric, and spark plug inserts. Two kit styles are available: economy kits include threaded inserts, an STI tap, and an installation tool; standard kits include inserts, an STI tap, a drill, and installation and tang break tools.</i></p>	<p>C191</p>
	<p>Install Tools & Tang Breaks</p>	<p>Tools <i>We offer a variety of mandrel-style installation tools and manual tang break tools for easy installation of our coil threaded inserts for metal. Various sizes are available to match the size of your inserts.</i></p>	<p>C192-C193</p>
<p>NEW</p> 	<p>Ultrasonic Inserts</p>	<p>Ultrasonic Inserts <i>We offer ultrasonic inserts for plastic in two varieties: tapered and straight. Both feature knurl/groove patterns designed for optimum torque and pull out resistance, and can be installed via an ultrasonic horn or heat driver.</i></p>	<p>C194</p>
	<p>Press Inserts for Thermoset Plastics</p>	<p>Press Inserts for Thermoset Plastics <i>Designed for post-molding installation in thermoset plastics and thermoplastics, our press inserts reduce the cost of moldings and eliminate the need to "chase" threads post-molding. All three styles—flush, flanged, and reverse slot—are designed for fast and easy "cold" installation. A variety of inch and metric thread sizes are available.</i></p>	<p>C195-C196</p>



Threaded Inserts

Inserts filetés



Inch
Pouce

STRONG THREADS MADE EASY

for holding strength.

All solid construction E-Z LOK threaded inserts install with standard tools. No special drills...no special taps...no special installation tools.

E-Z LOK external threads are standard size and pitch to permit the use of standard drills and taps.

E-Z LOKs can be installed with a screwdriver, bolt/jam nut (except IC series), or optional power drive tool.

E-Z LOKs will not back out or vibrate loose. Immediately upon installation, microencapsulated adhesive begins to set and the newly installed inserts are fastener-ready in 3-5 minutes.

The adhesive seals against liquids and gases to 6,000 psi when fully cured (72 hours).



Power drive tools are available for high volume installation... See insert tables for catalog numbers and sizes.



Drill hole with standard drill.



Tap hole with standard tap.



Turn E-Z LOK home flush with bolt.



CARBON STEEL INSERTS FOR METAL COARSE THREAD

Spaenaur No.	Mfr. No.	Internal Thread	External Thread	Length	Tap Drill Size	Tap Size	Minimum Full Thread Depth	PKG QTY.	Drive Tool Spaenaur No. (Sold Separately)
627-020	329-004	4-40	10-32	.250	5/32	10-32	9/32	10	-
627-021	329-006	6-32	1/4-20	.280	7	1/4-20	11/32	10	876-795
627-022	329-008	8-32	5/16-18	.290	F	5/16-18	7/16	10	876-790
627-001	329-3	10-24	3/8-16	.406	5/16	3/8-16	15/32	10	876-791
627-002	329-4	1/4-20	7/16-14	.437	23/64	7/16-14	1/2	10	876-792
627-003	329-5	5/16-18	1/2-13	.484	27/64	1/2-13	9/16	10	876-793
627-B04-1G	329-6	3/8-16	9/16-12	.515	31/64	9/16-12	19/32	10	876-F06-1T
627-005	329-7	7/16-14	5/8-11	.656	17/32	5/8-11	23/32	10	876-796
627-B81-1W	329-8	1/2-13	3/4-10	.656	21/32	3/4-10	3/4	10	876-796
627-B05-1W	329-10	5/8-11	7/8-9	.687	49/64	7/8-9	13/16	10	876-797
627-008	329-1018	5/8-11	7/8-9	1.125	49/64	7/8-9	1-1/4	10	876-797
627-B06-1M	329-12	3/4-10	1-8	.781	7/8	1-8	7/8	10	876-B60-1W
627-025	329-14	7/8-9	1-1/4-7	1.125	1-7/64	1-1/4-7	1-1/4	10	876-B60-1W
627-B07-1X	329-16	1-8	1-3/8-12	1.250	1-9/32	1-3/8-12	1-3/8	10	876-B60-1W



CARBON STEEL INSERTS FOR METAL FINE THREAD

Spaenaur No.	Mfr. No.	Internal Thread	External Thread	Length	Tap Drill Size	Tap Size	Minimum Full Thread Depth	PKG QTY.	Drive Tool Spaenaur No. (Sold Separately)
627-B93-1W	329-332	10-32	3/8-16	.406	5/16	3/8-16	15/32	10	876-790
627-B89-1T	329-428	1/4-28	7/16-14	.437	23/64	7/16-14	1/2	10	876-792
627-013	329-524	5/16-24	1/2-13	.484	27/64	1/2-13	9/16	10	876-793
627-014	329-624	3/8-24	9/16-12	.515	31/64	9/16-12	19/32	10	876-F06-1T
627-B80-1G	329-720	7/16-20	5/8-11	.656	17/32	5/8-11	23/32	10	876-F06-1T
627-016	329-820	1/2-20	3/4-10	.656	21/32	3/4-10	3/4	10	876-796
627-B09-1P	329-10F	5/8-18	7/8-9	.687	49/64	7/8-9	13/16	10	876-797
627-018	329-1216	3/4-16	1-8	.781	7/8	1-8	7/8	10	876-B60-1W

Inch and **Metric**
Pouce et **Métrique**



Threaded Inserts
Inserts filetés



CARBON STEEL INSERTS FOR METAL
METRIC THREAD – METRIC INTERNAL/METRIC EXTERNAL

Spaenaur No.	Mfr. No.	Internal Thread	External Thread	Length	Tap Drill Size	Tap Size	Minimum Full Thread Depth	PKG QTY.	Drive Tool Spaenaur No. (Sold Separately)
627-E91-1A	450-3	M3-0.5	M6-1.0	6.5 mm	5.1 mm	M6-1.0	7.8 mm	10	-
627-216	450-4	M4-0.7	M8-1.25	7.5 mm	6.9 mm	M8-1.25	9.0 mm	10	876-790
115499	450-5	M5-0.8	M8-1.25	7.5 mm	6.9 mm	M8-1.25	9.0 mm	10	876-790
627-E92-1P	450-6	M6-1.0	M10-1.5	10.5 mm	8.6 mm	M10-1.5	12.0 mm	10	876-792
627-E93-1Y	450-8	M8-1.25	M12-1.75	12.5 mm	10.4 mm	M12-1.75	14.5 mm	10	876-794
627-E94-1C	450-10	M10-1.5	M16-2.0	17.0 mm	14.0 mm	M16-2.0	19.0 mm	10	876-F06-1T
78541	450-12	M12-1.75	M16-2.0	17.0 mm	14.0 mm	M16-2.0	19.0 mm	10	876-795
116502	450-16	M16-2.0	M24-3.0	20.0 mm	21.0 mm	M24-3.0	24.0 mm	10	876-797
627-E95-1N	450-20	M20-2.5	M36-4.0	30.0 mm	33.0 mm	M36-4.0	35.0 mm	10	-
627-E96-1T	450-24	M24-3.0	M36-4.0	30.0 mm	33.0 mm	M36-4.0	35.0 mm	10	-



CARBON STEEL INSERTS FOR METAL – FINE THREAD
METRIC THREAD – METRIC INTERNAL/U.S. EXTERNAL

Spaenaur No.	Mfr. No.	Internal Thread	External Thread	Length	Tap Drill Size	Tap Size	Minimum Full Thread Depth	PKG QTY.	Drive Tool Spaenaur No. (Sold Separately)
627-200	650-6	M6-1.0	3/8-16	.406	5/16	3/8-16	15/32	10	876-792
627-201	650-8	M8-1.25	1/2-13	.484	27/64	1/2-13	9/16	10	876-793
627-202	650-10	M10-1.50	9/16-12	.515	31/64	9/16-12	19/32	10	876-F06-1T
627-203	650-12	M12-1.75	3/4-10	.656	21/32	3/4-10	3/4	10	876-795
627-204	650-14	M14-2.0	7/8-9	.687	49/64	7/8-9	13/16	10	876-796
627-B97-1P	650-16	M16-2.0	1-8	.781	7/8	1-8	7-8	10	876-797



CARBON STEEL INSERTS
AUTOMOTIVE

Spaenaur No.	Mfr. No.	Internal Thread	External Thread	Length	Tap Drill Size	Tap Size	PKG QTY.
627-206	329-1008	M10-1.0	9/16-18	.453	33/64	9/16-18	10
627-207	329-1208	M12-1.25	5/8-18	.453	37/64	5/8-18	10
627-B18-1M	329-1212	M12-1.25	5/8-18	.703	37/64	5/8-18	10
627-209	329-1406	M14-1.25	3/4-16	.328	11/16	3/4-16	10
627-B82-1M	329-1408	M14-1.25	3/4-16	.453	11/16	3/4-16	10
627-B83-1X	329-1412	M14-1.25	3/4-16	.703	11/16	3/4-16	10
627-B85-1P	329-1808	M18-1.5	1-12	.453	59/64	1-12	10



CARBON STEEL INSERTS
AUTOMOTIVE – VW CASE SAVERS

Spaenaur No.	Mfr. No.	Internal Thread	External Thread	Length	Tap Drill Size	Tap Size	PKG QTY.
627-B84-1A	330-10 (Open)	M10-1.50	9/16-12	1.000	31/64	9/16-12	10
627-214	330-11 (Closed)	M10-1.50	9/16-12	1.000	31/64	9/16-12	10



ASSORTMENT **805-422A**
ASSORTIMENT

Inch & Metric
STANDARD ASSORTMENT

STEEL
15 SIZES - 60 PIECES
Internal threads are **Metric**,
External are **Inch**
13-5/16" W. x 9-1/4" D. x 2" H.



For the complete assortment contents turn to A69

CATALOG 14
SPAENAUR

Threaded Inserts & Assortments

Inserts filetés et assortiments



Inch and Metric
Pouce et Métrique



**303 STAINLESS STEEL INSERTS FOR METAL
COARSE THREAD**

Spaenaur No.	Mfr. No.	Internal Thread	External Thread	Length	Tap Drill Size	Tap Size	Minimum Full Thread Depth	PKG QTY.	Drive Tool Spaenaur No. (Sold Separately)
627-800	303-3	10-24	3/8-16	.406	5/16	3/8-16	15/32	10	876-791
627-801	303-4	1/4-20	7/16-14	.437	23/64	7/16-14	1/2	10	876-792
627-802	303-5	5/16-18	1/2-13	.484	27/64	1/2-13	9/16	10	876-793
627-812	453-8	M8x1.25	M12x1.75	12.5	10.4	M12x1.75	14.5	10	876-793
627-B79-1W	303-6	3/8-16	9/16-12	.515	31/64	9/16-12	19/32	10	876-794
627-804	303-7	7/16-14	5/8-11	.656	17/32	5/8-11	23/32	10	876-795
627-805	303-8	1/2-13	3/4-10	.656	21/32	3/4-10	3/4	10	876-796



**303 STAINLESS STEEL INSERTS FOR METAL
FINE THREAD**

Spaenaur No.	Mfr. No.	Internal Thread	External Thread	Length in.	Tap Drill Size	Tap Size	Minimum Full Thread Depth	PKG QTY.	Drive Tool Spaenaur No. (Sold Separately)
627-806	303-332	10-32	3/8-16	.406	5/16	3/8-16	15/32	10	876-791
627-807	303-428	1/4-28	7/16-14	.437	23/64	7/16-14	1/2	10	876-792
627-B86-1Y	303-524	5/16-24	1/2-13	.484	27/64	1/2-13	9/16	10	876-793
627-B25-1Z	303-624	3/8-24	9/16-12	.515	31/64	9/16-12	19/32	10	876-794
627-810	303-720	7/16-20	5/8-11	.656	17/32	5/8-11	23/32	10	876-795
627-B87-1Z	303-820	1/2-20	3/4-10	.656	21/32	3/4-10	3/4	10	876-796

EZ LOK Inch
STANDARD ASSORTMENTS



ASSORTMENT
ASSORTIMENT **805-425B**

STEEL
21 SIZES - 60 PIECES
Coarse & Fine Thread

ASSORTMENT
ASSORTIMENT **805-423A**

303 STAINLESS STEEL
12 SIZES - 42 PIECES

Steel Drawer Size:
13-5/16" W. x 9-1/4" D. x 2" H.

Spaenaur No.	Internal Thread Size	External Thread Size	Internal Thread Depth	Qty.	Page
627-020	#4-40	#10-32	9/32"	4	C184
627-021	#6-32	1/4"-20	11/32"		
627-022	#8-32	5/16"-18	7/16"		
627-001	#10-24	3/8"-16	15/32"		
627-B93-1W	#10-32				
627-002	1/4"-20	7/16"-14	1/2"		
627-B89-1T	1/4"-28				
627-003	5/16"-18	1/2"-13	9/16"		
627-013	5/16"-24				
627-B04-1G	3/8"-16	9/16"-12	19/32"	3	
627-014	3/8"-24				
627-005	7/16"-14	5/8"-11	23/32"		
627-B80-1G	7/16"-20				
627-B81-1W	1/2"-13	3/4"-10	3/4"	2	
627-016	1/2"-20				
627-B05-1W	5/8"-11	7/8"-9	13/16"	1	
627-008			1-1/4"		
627-B09-1P	5/8"-18	1"-8	13/16"		
627-B06-1M	3/4"-10				
627-018	3/4"-16	1"-8	7/8"	1	
627-B07-1X	1"-8		1-3/8"-12		1-3/8"

Thread Type	Spaenaur No.	Internal Thread Size	External Thread Size	Overall Length	Qty.	Page	
Coarse	627-800	#10 - 24	3/8"-16	0.406"	6	C186	
	627-801	1/4"-20	7/16"-14	0.437"	5		
	627-802	5/16"-18	1/2"-13	0.484"	4		
	627-803	3/8"-16	9/16"-12	0.515"	2	C186	
	627-804	7/16"-14	5/8"-11	0.656"			
627-805	1/2"-13	3/4"-10	0.656"				
Fine	627-806	#10 - 32	3/8"-16	0.406"	6		C186
	627-807	1/4"-28	7/16"-14	0.437"	5		
	627-808	5/16"-24	1/2"-13	0.484"	4		
	627-B25-1Z	3/8"-24	9/16"-12	0.515"	2	C186	
	627-810	7/16"-20	5/8"-11	0.656"			
627-811	1/2"-20	3/4"-10	0.656"				

Inch
Pouce



Threaded Inserts

Inserts filetés

NEW

COIL THREADED INSERTS FOR METAL – UNC



Spaenaur No.	Mfr. No.	Size Thread	Length (in/mm)	Free O/D Min	Free O/D Max	PKG QTY.
627-C03-1A	20010	2-56 x 1D	0.086	0.109	0.113	10
627-C04-1P	20110	3-48 x 1D	0.099	0.126	0.134	10
627-C05-1Y	20210	4-40 x 1D	0.112	0.144	0.149	10
627-C06-1C	20310	5-40 x 1D	0.125	0.157	0.165	10
627-C07-1N	20410	6-32 x 1D	0.138	0.178	0.183	10
627-C08-1T	20510	8-32 x 1D	0.164	0.205	0.210	10
627-C09-1K	20610	10-24 x 1D	0.190	0.240	0.248	10
627-C10-1T	20710	12-24 x 1D	0.216	0.268	0.275	10
627-C11-1K	20810	1/4-20 x 1D	0.250	0.314	0.322	10
627-C12-1W	20910	5/16-18 x 1D	0.313	0.384	0.392	10
627-C19-1N	21010	3/8-16 x 1D	0.375	0.455	0.463	10
627-C13-1M	21110	7/16-14 x 1D	0.438	0.530	0.538	10
627-C14-1X	21210	1/2-13 x 1D	0.500	0.600	0.610	10
627-C15-1A	21310	9/16-12 x 1D	0.563	0.667	0.679	10
627-C16-1P	21410	5/8-11 x 1D	0.625	0.742	0.752	10
627-C20-1C	21510	3/4-10 x 1D	0.750	0.880	0.892	10
627-C17-1Y	21610	7/8-9 x 1D	0.875	1.019	1.033	10
627-C18-1C	21710	1-8 x 1D	1.000	1.162	1.179	10

NEW

COIL THREADED INSERTS FOR METAL – UNF



Spaenaur No.	Mfr. No.	Size Thread	Length (in/mm)	Free O/D Min	Free O/D Max	PKG QTY.
627-C21-1N	30210	4-48 x 1D	0.112	0.139	0.147	10
627-C22-1T	30410	6-40 x 1D	0.138	0.170	0.178	10
627-C23-1K	30510	8-36 x 1D	0.164	0.200	0.208	10
627-C24-1W	30610	10-32 x 1D	0.190	0.233	0.241	10
627-C25-1M	30810	1/4-28 x 1D	0.250	0.299	0.307	10
627-C26-1X	30910	5/16-24 x 1D	0.313	0.370	0.378	10
627-C34-1T	31010	3/8-24 x 1D	0.375	0.433	0.441	10
627-C27-1A	31110	7/16-20 x 1D	0.438	0.507	0.515	10
627-C28-1P	31210	1/2-20 x 1D	0.500	0.567	0.577	10
627-C29-1Y	31310	9/16-18 x 1D	0.563	0.630	0.642	10
627-C30-1P	31410	5/8-18 x 1D	0.625	0.694	0.706	10
627-C35-1K	31510	3/4-16 x 1D	0.750	0.831	0.841	10
627-C31-1Y	31610	7/8-14 x 1D	0.875	0.968	0.983	10
627-C32-1C	31710	1-14 x 1D	1.000	1.108	1.120	10
627-C33-1N	32210	1-12 x 1D	1.000	1.097	1.110	10

NEW

COIL THREADED INSERTS FOR METAL – UNC



Spaenaur No.	Mfr. No.	Size Thread	Length (in/mm)	Free O/D Min	Free O/D Max	PKG QTY.
627-D07-1X	20015	2-56 x 1.5D	0.129	0.109	0.113	10
627-D08-1A	20115	3-48 x 1.5D	0.148	0.126	0.134	10
627-D09-1P	20215	4-40 x 1.5D	0.168	0.144	0.149	10
627-D10-1A	20315	5-40 x 1.5D	0.188	0.157	0.165	10
627-D11-1P	20415	6-32 x 1.5D	0.207	0.178	0.183	10
627-D12-1Y	20515	8-32 x 1.5D	0.246	0.205	0.210	10
627-D13-1C	20615	10-24 x 1.5D	0.285	0.240	0.248	10
627-D14-1N	20715	12-24 x 1.5D	0.324	0.268	0.275	10
627-D15-1T	20815	1/4-20 x 1.5D	0.375	0.314	0.322	10
627-D16-1K	20915	5/16-18 x 1.5D	0.469	0.384	0.392	10
627-D17-1W	21015	3/8-16 x 1.5D	0.563	0.455	0.463	10
627-D18-1M	21115	7/16-14 x 1.5D	0.656	0.530	0.538	10
627-D19-1X	21215	1/2-13 x 1.5D	0.750	0.600	0.610	10
627-D20-1M	21315	9/16-12 x 1.5D	0.844	0.667	0.679	10
627-D21-1X	21415	5/8-11 x 1.5D	0.938	0.742	0.752	10
627-D28-1K	21515	3/4-10 x 1.5D	1.125	0.880	0.892	10
627-D22-1A	21615	7/8-9 x 1.5D	1.313	1.019	1.033	10
627-D23-1P	21715	1-8 x 1.5D	1.500	1.162	1.179	10
627-D24-1Y	21815	1-1/8-7 x 1.5D	1.688	1.315	1.355	10
627-D25-1C	21915	1-1/4-7 x 1.5D	1.875	1.443	1.483	10
627-D26-1N	22015	1-3/8-6 x 1.5D	2.063	1.598	1.643	10
627-D27-1T	22115	1-1/2-6 x 1.5D	2.250	1.716	1.728	10

CATALOG 14

SPAENAUR

E-Z Coil® is a registered trademark of TOOL COMPONENTS, INC.

© 2018 Spaenaur Inc. All rights reserved. Catalog may not be reproduced, in whole or in part, without the written permission of Spaenaur Inc. Subject to Catalog Terms and Conditions of Use available at Spaenaur.com and on page TC2 and TC3 at the back of this catalog.
© 2018 Spaenaur Inc. Tous droits réservés. Le catalogue ne peut être reproduit, en tout ou en partie, sans l'autorisation écrite de Spaenaur Inc. L'utilisation est soumise aux Conditions d'utilisation du Catalogue disponibles sur Spaenaur.com et à la page TC4 et TC5 à la fin de ce catalogue.

C187

Threaded Inserts

Inserts filetés



Inch
Pouce

NEW

COIL THREADED INSERTS FOR METAL – UNF



Spaenaur No.	Mfr. No.	Size Thread	Length (in/mm)	Free O/D Min	Free O/D Max	PKG QTY.
627-D29-1W	30215	4-48 x 1.5D	0.168	0.139	0.147	10
627-D30-1K	30415	6-40 x 1.5D	0.207	0.170	0.178	10
627-D31-1W	30515	8-36 x 1.5D	0.246	0.200	0.208	10
627-D32-1M	30615	10-32 x 1.5D	0.285	0.233	0.241	10
627-D33-1X	30815	1/4-28 x 1.5D	0.375	0.299	0.307	10
627-D34-1A	30915	5/16-24 x 1.5D	0.469	0.370	0.378	10
627-D35-1P	31015	3/8-24 x 1.5D	0.563	0.433	0.441	10
627-D36-1Y	31115	7/16-20 x 1.5D	0.656	0.507	0.515	10
627-D37-1C	31215	1/2-20 x 1.5D	0.750	0.567	0.577	10
627-D38-1N	31315	9/16-18 x 1.5D	0.844	0.630	0.642	10
627-D39-1T	31415	5/8-18 x 1.5D	0.938	0.694	0.706	10
627-D47-1P	31515	3/4-16 x 1.5D	1.125	0.831	0.841	10
627-D40-1N	31615	7/8-14 x 1.5D	1.313	0.968	0.983	10
627-D41-1T	31715	1-14 x 1.5D	1.500	1.097	1.120	10
627-D42-1K	31815	1-1/8-12 x 1.5D	1.688	1.304	1.334	10
627-D43-1W	31915	1-1/4-12 x 1.5D	1.875	1.439	1.469	10
627-D44-1M	32015	1-3/8-12 x 1.5D	2.063	1.575	1.610	10
627-D45-1X	32115	1-1/2-12 x 1.5D	2.250	1.710	1.745	10
627-D46-1A	32215	1-12 x 1.5D	1.500	1.080	1.120	10

NEW

COIL THREADED INSERTS FOR METAL – UNC



Spaenaur No.	Mfr. No.	Size Thread	Length (in/mm)	Free O/D Min	Free O/D Max	PKG QTY.
627-C55-1Y	20020	2-56 x 2D	0.172	0.109	0.113	10
627-C56-1C	20120	3-48 x 2D	0.198	0.126	0.134	10
627-C57-1N	20220	4-40 x 2D	0.224	0.144	0.149	10
627-C58-1T	20320	5-40 x 2D	0.250	0.157	0.165	10
627-C59-1K	20420	6-32 x 2D	0.276	0.178	0.183	10
627-C60-1T	20520	8-32 x 2D	0.328	0.205	0.210	10
627-C61-1K	20620	10-24 x 2D	0.380	0.240	0.248	10
627-C62-1W	20720	12-24 x 2D	0.432	0.268	0.275	10
627-C63-1M	20820	1/4-20 x 2D	0.500	0.314	0.322	10
627-C64-1X	20920	5/16-18 x 2D	0.625	0.384	0.392	10
627-C65-1A	21020	3/8-16 x 2D	0.750	0.455	0.463	10
627-C66-1P	21120	7/16-14 x 2D	0.875	0.530	0.538	10
627-C67-1Y	21220	1/2-13 x 2D	1.000	0.600	0.610	10
627-C68-1C	21320	9/16-12 x 2D	1.125	0.667	0.679	10
627-C69-1N	21420	5/8-11 x 2D	1.250	0.742	0.752	10
627-C70-1C	21520	3/4-10 x 2D	1.500	0.880	0.892	10
627-C71-1N	21620	7/8-9 x 2D	1.750	1.019	1.033	10
627-C72-1T	21720	1-8 x 2D	2.000	1.162	1.179	10

NEW

COIL THREADED INSERTS FOR METAL – UNF



Spaenaur No.	Mfr. No.	Size Thread	Length (in/mm)	Free O/D Min	Free O/D Max	PKG QTY.
627-C73-1K	30220	4-48 x 2D	0.224	0.139	0.147	10
627-C74-1W	30420	6-40 x 2D	0.276	0.170	0.178	10
627-C75-1M	30520	8-36 x 2D	0.238	0.200	0.208	10
627-C76-1X	30620	10-32 x 2D	0.380	0.233	0.241	10
627-C77-1A	30820	1/4-28 x 2D	0.500	0.299	0.307	10
627-C78-1P	30920	5/16-24 x 2D	0.625	0.370	0.378	10
627-C79-1Y	31020	3/8-24 x 2D	0.750	0.433	0.441	10
627-C80-1P	31120	7/16-20 x 2D	0.875	0.507	0.515	10
627-C81-1Y	31220	1/2-20 x 2D	1.000	0.567	0.577	10
627-E90-1X	31320	9/16-18 x 2D	1.125	0.630	0.642	10
627-C82-1C	31420	5/8-18 x 2D	1.250	0.694	0.706	10
627-C83-1N	31520	3/4-16 x 2D	1.500	0.831	0.841	10
627-C84-1T	31620	7/8-14 x 2D	1.750	0.968	0.983	10
627-C85-1K	31720	1-14 x 2D	2.000	1.108	1.120	10
627-C86-1W	32220	1-12 x 2D	2.000	1.097	1.110	10

Metric
Métrique



Threaded Inserts
Inserts filetés

NEW



COIL THREADED INSERTS FOR METAL – METRIC COARSE

Spaenaur No.	Mfr. No.	Size	Length (in/mm)	Free O/D Min	Free O/D Max	PKG QTY.
627-C36-1W	40110	M2.5-.45 x 1D	2.5 mm	3.1	3.2	10
627-C37-1M	40210	M3-0.5 x 1D	3 mm	3.6	3.7	10
627-C38-1X	40310	M3.5-0.6 x 1D	3.5 mm	4.3	4.5	10
627-C39-1A	40410	M4-0.7 x 1D	4 mm	4.8	4.9	10
627-C40-1X	40510	M5-0.8 x 1D	5 mm	6.0	6.2	10
627-C41-1A	40610	M6-1.0 x 1D	6 mm	7.3	7.4	10
627-C42-1P	40710	M7-1.0 x 1D	7 mm	8.3	8.6	10
627-C43-1Y	40810	M8-1.25 x 1D	8 mm	9.7	9.9	10
627-C44-1C	40910	M10-1.5 x 1D	10 mm	11.9	12.1	10
627-C49-1M	41010	M12-1.75 x 1D	12 mm	14.3	14.5	10
627-C45-1N	41110	M14-2.0 x 1D	14 mm	16.6	17.0	10
627-C46-1T	41210	M16-2 x 1D	16 mm	18.6	18.9	10
627-C47-1K	41310	M18-2.5 x 1D	18 mm	21.2	21.6	10
627-C48-1W	41410	M20-2.5 x 1D	20 mm	23.2	23.6	10

NEW



COIL THREADED INSERTS FOR METAL – METRIC FINE

Spaenaur No.	Mfr. No.	Size	Length (in/mm)	Free O/D Min	Free O/D Max	PKG QTY.
627-C50-1W	50810	M8-1.0 x 1D	8 mm	9.3	9.6	10
627-C51-1M	50910	M10-1.25 x 1D	10 mm	11.6	11.9	10
627-C54-1P	51010	M12-1.5 x 1D	12 mm	13.9	14.3	10
627-C52-1X	51110	M14-1.5 x 1D	14 mm	16.0	16.3	10
627-C53-1A	51210	M16-1.5 x 1D	16 mm	18.0	18.3	10

NEW



COIL THREADED INSERTS FOR METAL – METRIC COARSE

Spaenaur No.	Mfr. No.	Size	Length (in/mm)	Free O/D Min	Free O/D Max	PKG QTY.
627-D48-1Y	40115	M2.5-.45 x 1.5D	3.75 mm	3.1	3.2	10
627-D49-1C	40215	M3-0.5 x 1.5D	4.5 mm	3.6	3.7	10
627-D50-1Y	40315	M3.5-0.6 x 1.5D	5.25 mm	4.3	4.5	10
627-D51-1C	40415	M4-0.7 x 1.5D	6 mm	4.8	4.9	10
627-D52-1N	40515	M5-0.8 x 1.5D	7.5 mm	6.0	6.2	10
627-D53-1T	40615	M6-1.0 x 1.5D	9 mm	7.3	7.4	10
627-D54-1K	40715	M7-1.0 x 1.5D	10.5 mm	8.3	8.6	10
627-D55-1W	40815	M8-1.25 x 1.5D	12 mm	9.7	9.9	10
627-D56-1M	40915	M10-1.5 x 1.5D	15 mm	11.9	12.1	10
627-D57-1X	41015	M12-1.75 x 1.5D	18 mm	13	13.3	10
627-D58-1A	41115	M14-2.0 x 1.5D	21 mm	14.3	14.5	10
627-D59-1P	41215	M16-2 x 1.5D	24 mm	16.6	17.0	10
627-D60-1A	41315	M18-2.5 x 1.5D	27 mm	18.6	18.9	10
627-D61-1P	41415	M20-2.5 x 1.5D	30 mm	21.2	21.6	10
627-D62-1Y	42215	M11-1.5 x 1.5D	16.5 mm	23.2	23.6	10

NEW



COIL THREADED INSERTS FOR METAL – METRIC FINE

Spaenaur No.	Mfr. No.	Size	Length (in/mm)	Free O/D Min	Free O/D Max	PKG QTY.
627-D63-1C	50815	M8-1.0 x 1.5D	12 mm	9.3	9.6	10
627-D64-1N	50915	M10-1.25 x 1.5D	15 mm	11.6	11.9	10
627-D65-1T	51015	M12-1.5 x 1.5D	18 mm	13.9	14.3	10
627-D66-1K	51115	M14-1.5 x 1.5D	21 mm	16.0	16.3	10
627-D67-1W	51215	M16-1.5 x 1.5D	24 mm	18.0	18.3	10

CATALOG 14 SPAENAUR

Threaded Inserts / Assortment

Inserts filetés et assortiments



Metric
Métrique

NEW

COIL THREADED INSERTS FOR METAL – METRIC COARSE



Spaenaur No.	Mfr. No.	Size	Length (in/mm)	Free O/D Min	Free O/D Max	PKG QTY.
627-C87-1M	40120	M2.5-.45 x 2D	5 mm	3.1	3.2	10
627-C88-1X	40220	M3-0.5 x 2D	6 mm	3.6	3.7	10
627-C89-1A	40320	M3.5-0.6 x 2D	7 mm	4.3	4.5	10
627-C90-1X	40420	M4-0.7 x 2D	8 mm	4.8	4.9	10
627-C91-1A	40520	M5-0.8 x 2D	10 mm	6.0	6.2	10
627-C92-1P	40620	M6-1.0 x 2D	12 mm	7.3	7.4	10
627-C93-1Y	40720	M7-1.0 x 2D	14 mm	8.3	8.6	10
627-C94-1C	40820	M8-1.25 x 2D	16 mm	9.7	9.9	10
627-C95-1N	40920	M10-1.5 x 2D	20 mm	11.9	12.1	10
627-C96-1T	41020	M12-1.75 x 2D	24 mm	14.3	14.5	10
627-C97-1K	41120	M14-2.0 x 2D	28 mm	16.6	17.0	10
627-C98-1W	41220	M16-2 x 2D	32 mm	18.6	18.9	10
627-C99-1M	41320	M18-2.5 x 2D	36 mm	21.2	21.6	10
627-D01-1C	41420	M20-2.5 x 2D	40 mm	23.2	23.6	10

NEW

COIL THREADED INSERTS FOR METAL – METRIC FINE



Spaenaur No.	Mfr. No.	Size	Length (in/mm)	Free O/D Min	Free O/D Max	PKG QTY.
627-D02-1N	50820	M8-1.0 x 2D	16 mm	9.3	9.6	10
627-D03-1T	50920	M10-1.25 x 2D	20 mm	11.6	11.9	10
627-D04-1K	51020	M12-1.5 x 2D	24 mm	13.9	14.3	10
627-D05-1W	51120	M14-1.5 x 2D	28 mm	16.0	16.3	10
627-D06-1M	51220	M16-1.5 x 2D	32 mm	18.0	18.3	10

STEEL

Inch & Metric
STANDARD ASSORTMENT

15 SIZES - 60 PIECES

Internal threads are Metric, External are Inch
13-5/16" W. x 9-1/4" D. x 2" H.



ASSORTMENT 805-422A



Name	Spaenaur No.	Internal Thread	External Thread	Length	Qty.	Page
Carbon Steel Inserts for Metal - Fine Thread	627-200	M6-1.00	3/8"-16	0.406"	5	C185
	627-201	M8-1.25	1/2"-13	0.484"		
	627-202	M10-1.50	9/16"-12	0.515"	4	
	627-203	M12-1.75	3/4"-10	0.656"		
	627-204	M14-2.00	7/8"-9	0.687"	3	
627-B97-1P	M16-2.00	1"-8	0.781"			
Carbon Steel Inserts - Automotive	627-206	M10-1.00	9/16"-18	0.453"	4	
	627-207	M12-1.25	5/8"-18	0.453"		
	627-B18-1M			0.703"		
	627-209	M14-1.25	3/4"-16	0.328"		
	627-B82-1M			0.453"		
	627-B83-1X			0.703"		
Carbon Steel Inserts - Automotive VW Case Savers	627-B85-1P	M18-1.50	1"-12	0.453"	4	
	627-214	M10-1.50	9/16"-12	1.000"		
627-B84-1A						

SPAENAUR CATALOG 14

Inch and Metric
Pouce et Métrique



Threaded Insert Repair Kits
Kits de réparation pour inserts filetés

NEW



COIL INSERT THREAD REPAIR KIT – STANDARD

Includes inserts, drill, tap, install tool and tang break

Spaenaur No.	Mfr. No.	Size	No. of Inserts
627-E64-1X	SK20215	4-40 x 1.5D	10
627-E65-1A	SK20315	5-40 x 1.5D	10
627-E66-1P	SK20415	6-32 x 1.5D	10
627-E67-1Y	SK20515	8-32 x 1.5D	10
627-E68-1C	SK20615	10-24 x 1.5D	10
627-E69-1N	SK20715	12-24 x 1.5D	10
627-E70-1C	SK20815	1/4-20 x 1.5D	10
627-E71-1N	SK20915	5/16-18 x 1.5D	10
627-E72-1T	SK21015	3/8-16 x 1.5D	10
627-E73-1K	SK30215	4-48 x 1.5D	10
627-E74-1W	SK30415	6-40 x 1.5D	10
627-E75-1M	SK30515	8-36 x 1.5D	10
627-E76-1X	SK30615	10-32 x 1.5D	10
627-E77-1A	SK30815	1/4-28 x 1.5D	10
627-E78-1P	SK30915	5/16-24 x 1.5D	10
627-E79-1Y	SK31015	3/8-24 x 1.5D	10

Spaenaur No.	Mfr. No.	Size	No. of Inserts
627-E80-1P	SK40215	M3-0.5 x 1.5D	10
627-E81-1Y	SK40315	M3.5-0.6 x 1.5D	10
627-E82-1C	SK40415	M4-0.7 x 1.5D	10
627-E83-1N	SK40515	M5-0.8 x 1.5D	10
627-E84-1T	SK40615	M6-1.0 x 1.5D	10
627-E85-1K	SK40715	M7-1.0 x 1.5D	10
627-E86-1W	SK40815	M8-1.25 1.5D	10
627-E87-1M	SK40915	M10-1.5 x 1.5D	10
627-E88-1X	SK50815	M8-1.0 x 1.5D	10
627-E89-1A	SK50915	M10-1.25 x 1.5D	10

Kits with 1D or 2D lengths available on request

NEW



COIL INSERT THREAD REPAIR KIT – ECONOMY

Includes inserts, tap and install tool

Spaenaur No.	Mfr. No.	Size	No. of Inserts
627-D98-1Y	EK20215	4-40 x 1.5D	10
627-D99-1C	EK20315	5-40 x 1.5D	10
627-E01-1M	EK20415	6-32 x 1.5D	10
627-E02-1X	EK20515	8-32 x 1.5D	10
627-E03-1A	EK20615	10-24 x 1.5D	10
627-E04-1P	EK20715	12-24 x 1.5D	10
627-E05-1Y	EK20815	1/4-20 x 1.5D	10
627-E06-1C	EK20915	5/16-18 x 1.5D	10
627-E07-1N	EK21015	3/8-16 x 1.5D	10
627-E08-1T	EK21115	7/16-14 x 1.5D	5
627-E09-1K	EK21215	1/2-13 x 1.5D	5
627-E10-1T	EK21315	9/16-12 x 1.5D	5
627-E11-1K	EK21415	5/8-11 x 1.5D	5
627-E12-1W	EK21515	3/4-10 x 1.5D	5
627-E13-1M	EK21615	7/8-9 x 1.5D	5
627-E14-1X	EK21715	1-8 x 1.5D	5
627-E15-1A	EK30215	4-48 x 1.5D	10
627-E16-1P	EK30415	6-40 x 1.5D	10
627-E17-1Y	EK30515	8-36 x 1.5D	10
627-E18-1C	EK30615	10-32 x 1.5D	10
627-E19-1N	EK30815	1/4-28 x 1.5D	10
627-E20-1C	EK30915	5/16-24 x 1.5D	10
627-E21-1N	EK31015	3/8-24 x 1.5D	10
627-E22-1T	EK31115	7/16-20 x 1.5D	5
627-E23-1K	EK31215	1/2-20 x 1.5D	5
627-E24-1W	EK31315	9/16-18 x 1.5D	5
627-E25-1M	EK31415	5/8-18 x 1.5D	5
627-E26-1X	EK31515	3/4-16 x 1.5D	5
627-E27-1A	EK31615	7/8-14 x 1.5D	5
627-E28-1P	EK31715	1-14 x 1.5D	5
627-E29-1Y	EK32215	1-12 x 1.5D	5

Spaenaur No.	Mfr. No.	Size	No. of Inserts
627-E30-1P	EK40215	M3-0.5 x 1.5D	10
627-E31-1Y	EK40315	M3.5-0.6 x 1.5D	10
627-E32-1C	EK40415	M4-0.7 x 1.5D	10
627-E33-1N	EK40515	M5-0.8 x 1.5D	10
627-E34-1T	EK40615	M6-1.0 x 1.5D	10
627-E35-1K	EK40715	M7-1.0 x 1.5D	10
627-E36-1W	EK40815	M8-1.25 1.5D	10
627-E37-1M	EK40915	M10-1.5 x 1.5D	10
627-E38-1X	EK42215	M11-1.5 x 1.5D	5
627-E39-1A	EK41015	M12-1.75 x 1.5D	5
627-E40-1X	EK41115	M14-2.0 x 1.5D	5
627-E41-1A	EK41215	M16-2.0 x 1.5D	5
627-E42-1P	EK41315	M18-2.5 x 1.5D	5
627-E43-1Y	EK41415	M20-2.5 x 1.5D	5
627-E44-1C	EK41515	M22-2.5 x 1.5D	5
627-E45-1N	EK41615	M24-3 x 1.5D	5
627-E46-1T	EK50815	M8-1.0 x 1.5D	10
627-E47-1K	EK50915	M10-1.25 x 1.5D	10
627-E50-1W	EK50932	M10-1.0 x .375	10
627-E53-1A	EK50933	M10-1.0 x .438	10
627-E57-1N	EK51015	M12-1.5 x 1.5D	5
627-E58-1T	EK51034	M12-1.25 x .500	5
627-E61-1K	EK51036	M12-1.25 x .750	5
627-E62-1W	EK51115	M14-1.5 x 1.5D	5
627-E54-1P	EK51132	M14-1.25 x .375	5
627-E55-1Y	EK51134	M14-1.25 x .500	5
627-E56-1C	EK51136	M14-1.25 x .750	5
627-E57-1N	EK51215	M16-1.5 x 1.5D	5
657-E58-1T	EK51315	M18-2.0 x 1.5D	5
627-E59-1K	EK51334	M18-1.5 x .500	5
627-E60-1T	EK51335	M18-1.5 x .625	5
627-E61-1K	EK51415	M20-2.0 x 1.5D	5
627-E62-1W	EK51515	M22-2.0 x 1.5D	5
627-E63-1M	EK51615	M24-2 x 1.5D	5

Kits with 1D or 2D lengths available on request

CATALOG 14

SPAENAUR

Threaded Insert Installation Tools

Outils d'installation pour inserts filetés



Inch and Metric
Pouce et Métrique



INSTALL TOOLS & TANG BREAKS – UNC

Spaenaur No.	For Use With	Install Tool Mfr. No.	PKG QTY.	Spaenaur No.	Tang Break Off Tool Mfr. No.	PKG QTY.
876-F57-1K	2-56	M1002	1	876-F77-1Y	T2002	1
876-F58-1W	4-40	M1004	1	876-F78-1C	T2004	1
876-F58-1W	5-40	M1004	1	876-F78-1C	T2004	1
876-F59-1M	6-32	M1005	1	876-F79-1N	T2005	1
876-F60-1W	8-32	M1006	1	876-F80-1C	T2006	1
876-F61-1M	10-24	M1007	1	876-F81-1N	T2008	1
876-F62-1X	12-24	M1008	1	876-F81-1N	T2008	1
876-F63-1A	1/4-20	M1009	1	876-F82-1T	T2009	1
876-F64-1P	5/16-18	M1010	1	876-F83-1K	T2010	1
876-F65-1Y	3/8-16	M1012	1	876-F85-1M	T2012	1
876-F66-1C	7/16-14	M1014	1	876-F87-1A	T2014	1
876-F67-1N	1/2-13	M1015	1	876-F88-1P	T2015	1
876-F68-1T	9/16-12	M1016	1	876-F88-1P	T2015	1
876-F69-1K	5/8-11	M1018	1	-	-	-
876-F70-1T	3/4-10	M1020	1	-	-	-
876-F71-1K	7/8-9	M1022	1	-	-	-
876-F72-1W	1-8	M1023	1	-	-	-
876-F73-1M	1-1/8-7	M1024	1	-	-	-



INSTALL TOOLS & TANG BREAKS – UNF

Spaenaur No.	For Use With	Install Tool Mfr. No.	PKG QTY.	Spaenaur No.	Tang Break Off Tool Mfr. No.	PKG QTY.
876-F58-1W	4-48	M1004	1	876-F78-1C	T2004	1
876-F59-1M	6-40	M1005	1	876-F79-1N	T2005	1
876-F60-1W	8-36	M1006	1	876-F80-1C	T2006	1
876-F62-1X	10-32	M1008	1	876-F81-1N	T2008	1
876-F63-1A	1/4-28	M1009	1	876-F82-1T	T2009	1
876-F65-1Y	5/16-24	M1011	1	876-F84-1W	T2011	1
876-F67-1N	3/8-24	M1013	1	876-F86-1X	T2013	1
876-F68-1T	7/16-20	M1014	1	876-F87-1A	T2014	1
876-F69-1K	1/2-20	M1015	1	876-F88-1P	T2015	1
876-F70-1T	9/16-18	M1016	1	876-F88-1P	T2015	1
876-F72-1W	5/8-18	M1018	1	-	-	-
876-F74-1X	3/4-16	M1021	1	-	-	-
876-F75-1A	7/8-14	M1022	1	-	-	-
876-F76-1P	1-14	M1023	1	-	-	-
876-F76-1P	1-12	M1023	1	-	-	-



INSTALL TOOLS & TANG BREAKS – METRIC COARSE

Spaenaur No.	For Use With	Install Tool Supplier No.	PKG QTY.	Spaenaur No.	Tang Break Off Tool Mfr. No.	PKG QTY.
876-F57-1K	M2-0.4	M1002	1	876-F77-1Y	T2002	1
876-F57-1K	M2.5-.45	M1002	1	876-F77-1Y	T2002	1
876-F58-1W	M3-0.5	M1004	1	876-F78-1C	T2004	1
876-F59-1M	M3.5-0.6	M1005	1	876-F79-1N	T2005	1
876-F60-1W	M4-0.7	M1006	1	876-F80-1C	T2006	1
876-F62-1X	M5-0.8	M1008	1	876-F81-1N	T2008	1
876-F63-1A	M6-1.0	M1009	1	876-F82-1T	T2009	1
876-F64-1P	M7-1.0	M1010	1	876-F83-1K	T2010	1
876-F65-1Y	M8-1.25	M1011	1	876-F84-1W	T2011	1
876-F67-1N	M10-1.5	M1013	1	876-F86-1X	T2013	1
876-F68-1T	M11-1.5	M1014	1	876-F87-1A	T2014	1
876-F69-1K	M12-1.75	M1015	1	876-F88-1P	T2015	1
876-F70-1T	M14-2.0	M1016	1	-	-	-
876-F72-1W	M16-2.0	M1018	1	-	-	-
876-F73-1M	M18-2.5	M1020	1	-	-	-
876-F74-1X	M20-2.5	M1021	1	-	-	-
876-F75-1A	M22-2.5	M1022	1	-	-	-
876-F76-1P	M24-3.0	M1023	1	-	-	-

Metric
Métrique



Threaded Insert Installation Tools
Outils d'installation pour inserts filetés



INSTALL TOOLS & TANG BREAKS – METRIC FINE

Spaenaur No.	For Use With	Install Tool Mfr. No.	PKG QTY.	Spaenaur No.	Tang Break Off Tool Mfr. No.	PKG QTY.
876-F65-1Y	M8-1.0	M1011	1	876-F84-1W	T2011	1
876-F57-1K	M2.5-.45	M1013	1	876-F86-1X	T2013	1
876-F58-1W	M3-0.5	M1015	1	876-F88-1P	T2015	1
876-F59-1M	M3.5-0.6	M1016	1	876-F88-1P	T2015	1
876-F60-1W	M4-0.7	M1018	1			
876-F62-1X	M5-0.8	M1020	1			
876-F63-1A	M6-1.0	M1020	1			
876-F64-1P	M7-1.0	M1021	1			
876-F65-1Y	M8-1.25	M1022	1			



INSTALL TOOLS & TANG BREAKS – SPARK PLUG

Spaenaur No.	For Use With	Install Tool Mfr. No.	PKG QTY.	Spaenaur No.	Tang Break Off Tool Mfr. No.	PKG QTY.
876-F67-1N	M10-1.0	M1013	1	876-F86-1X	T2013	1
876-F69-1K	M12-1.25	M1015	1	876-F88-1P	T2015	1
876-F71-1K	M14-1.25	M1017	1	876-F88-1P	T2015	1
876-F73-1M	M18-1.5	M1020	1			



ASSORTMENT 805-425B

Inch & Metric STEEL
21 SIZES - 60 PIECES
Coarse & Fine Thread



Steel Drawer Size:
13-5/16" W. x 9-1/4" D. x 2" H.

Spaenaur No.	Internal Thread Size	External Thread Size	Internal Thread Depth	Qty.	Page
627-020	#4-40	#10-32	9/32"	4	C184
627-021	#6-32	1/4"-20	11/32"		
627-022	#8-32	5/16"-18	7/16"		
627-001	#10-24	3/8"-16	15/32"		
627-B93-1W	#10-32				
627-002	1/4"-20	7/16"-14	1/2"	3	
627-B89-1T	1/4"-28	1/2"-13	9/16"		
627-003	5/16"-18				
627-013	5/16"-24	3/4"-10	3/4"	2	
627-B04-1G	3/8"-16		9/16"-12		
627-014	3/8"-24	5/8"-11		23/32"	
627-005	7/16"-14		1"-8	7/8"	1
627-B80-1G	7/16"-20	13/16"		1-1/4"	
627-B81-1W	1/2"-13		7/8"-9	13/16"	
627-016	1/2"-20	5/8"-18		13/16"	
627-B05-1W	5/8"-11		3/4"-10	1"	
627-008	5/8"-18	1"-8		7/8"	
627-B09-1P	3/4"-10		1-3/8"-12	1-3/8"	
627-B06-1M	3/4"-16				
627-018	1"-8				
627-B07-1X	1"-8				

CATALOG 14

SPAENAUR

Ultrasonic Inserts - Tapered

Inserts par ultrasons – coniques



Inch and Metric
Pouce et Métrique

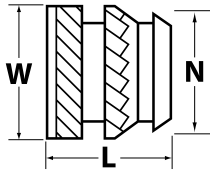

Single Vane

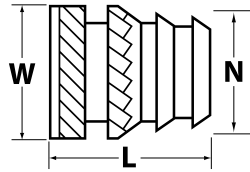

Double Vane

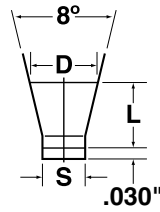

Hole depth should be a minimum of .030" greater than the length of the insert in blind holes.

DESIGNED FOR USE IN THERMOPLASTICS

- TAPERED DESIGN REDUCES INSTALLATION TIME
- INSTALL ULTRASONICALLY OR WITH HEAT DRIVER
- SUPERIOR TORQUE/PULL OUT RESISTANCE
- UNC AND METRIC THREADS
- SINGLE AND DOUBLE VANE

NEW

ULTRASONIC INSERTS – TAPERED SINGLE VANE



Spaenaur No.	Mfr. No.	Size	Overall Length (L)	Insert Diameter (W)	Pilot Diameter (N)	Rec. Hole Size* (D)	Rec. Hole Size* (S)	Min. Wall Thickness	PKG QTY.
627-D83-1X	TH-002-SV	2-56	0.115	0.136	0.122	0.123	0.118	0.080	10
627-D84-1A	TH-004-SV	4-40	0.135	0.172	0.157	0.159	0.153	0.093	10
627-D85-1P	TH-006-SV	6-32	0.150	0.220	0.203	0.206	0.199	0.116	10
627-D86-1Y	TH-008-SV	8-32	0.185	0.250	0.230	0.234	0.226	0.133	10
627-D87-1C	TH-124-SV	10-24	0.225	0.296	0.272	0.277	0.267	0.159	10
627-D88-1N	TH-132-SV	10-32	0.225	0.296	0.272	0.277	0.267	0.159	10
627-D91-1T	TH-420-SV	1/4-20	0.300	0.375	0.354	0.363	0.349	0.194	10
627-D92-1K	TH-518-SV	5/16-18	0.335	0.469	0.439	0.448	0.431	0.245	10
627-D89-1T	TH-316-SV	3/8-16	0.375	0.563	0.530	0.540	0.523	0.293	10
627-D90-1N	TH-324-SV	3/8-24	0.375	0.563	0.530	0.540	0.523	0.293	10
627-D93-1W	TH-M25-SV	M2.5-0.4	0.135	0.172	0.157	0.159	0.153	0.093	10
627-D94-1M	TH-M30-SV	M3-0.5	0.150	0.220	0.203	0.206	0.199	0.116	10
627-D95-1X	TH-M40-SV	M4-0.7	0.185	0.250	0.230	0.234	0.226	0.133	10
627-D96-1A	TH-M50-SV	M5-0.8	0.265	0.328	0.308	0.315	0.303	0.171	10
627-D97-1P	TH-M60-SV	M6-1.0	0.300	0.375	0.354	0.363	0.349	0.194	10

* Hole size requirements may vary depending on a number of factors, including material and tools. We recommend that you test your particular application before ordering.

NEW

ULTRASONIC INSERTS – TAPERED DOUBLE VANE



Spaenaur No.	Mfr. No.	Size	Overall Length (L)	Insert Diameter (W)	Pilot Diameter (N)	Rec. Hole Size* (D)	Rec. Hole Size* (S)	Min. Wall Thickness	PKG QTY.
627-D68-1M	DV-002-TH	2-56	0.188	0.136	0.115	0.123	0.107	0.080	10
627-D69-1X	DV-004-TH	4-40	0.219	0.172	0.144	0.159	0.141	0.093	10
627-D70-1M	DV-006-TH	6-32	0.250	0.220	0.190	0.206	0.185	0.116	10
627-D71-1X	DV-008-TH	8-32	0.312	0.250	0.212	0.234	0.208	0.133	10
627-D72-1A	DV-124-TH	10-24	0.375	0.297	0.251	0.277	0.246	0.159	10
627-D73-1P	DV-132-TH	10-32	0.375	0.297	0.251	0.277	0.246	0.159	10
627-D75-1C	DV-420-TH	1/4-20	0.500	0.375	0.332	0.363	0.321	0.194	10
627-D76-1N	DV-428-TH	1/4-28	0.500	0.375	0.332	0.363	0.321	0.194	10
627-D77-1T	DV-518-TH	5/16-18	0.562	0.469	0.406	0.448	0.401	0.245	10
627-D74-1Y	DV-316-TH	3/8-16	0.625	0.563	0.493	0.540	0.488	0.293	10
627-D78-1K	DV-M25-TH	M2.5-0.4	0.219	0.172	0.144	0.159	0.141	0.093	10
627-D79-1W	DV-M30-TH	M3-0.5	0.250	0.220	0.190	0.206	0.185	0.116	10
627-D80-1K	DV-M40-TH	M4-0.7	0.312	0.250	0.212	0.234	0.208	0.133	10
627-D81-1W	DV-M50-TH	M5-0.8	0.438	0.328	0.283	0.315	0.278	0.171	10
627-D82-1M	DV-M60-TH	M6-1.0	0.500	0.375	0.332	0.363	0.321	0.194	10

* Hole size requirements may vary depending on a number of factors, including material and tools. We recommend that you test your particular application before ordering.

Inch and Metric
Pouce et Métrique



Press Inserts for Thermoset Plastics

Inserts pour presse pour thermoplastiques



**PRESS INSERTS FOR THERMOSET PLASTICS
BRASS - FLUSH**

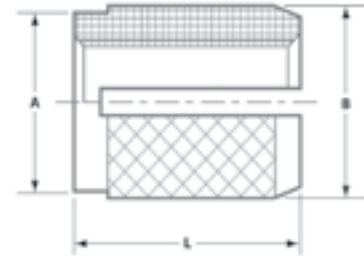

Spaenaur	Mfr. No.	Internal Thread	A ±.010"	B ±.010"	L ±.010"	Starting Hole Size	PKG QTY.
628-514	240-000-BR	0-80	.094	.104	.125	.094 (3/32)	10
628-515	240-002-BR	2-56	.125	.135	.156	.125 (1/8)	10
628-B29-1G	240-004-BR	4-40	.156	.166	.188	.156 (5/32)	10
628-517	240-006-BR	6-32	.187	.199	.250	.188 (3/16)	10
628-B31-1G	240-008-BR	8-32	.218	.230	.250	.219 (7/32)	10
628-B32-1W	240-332-BR	10-32	.250	.262	.375	.250 (1/4)	10
628-B33-1M	240-3-BR	10-24	.250	.262	.375	.250 (1/4)	10
628-B34-1X	240-4-BR	1/4-20	.312	.326	.500	.313 (5/16)	10
628-522	240-5-BR	5/16-18	.375	.389	.563	.375 (3/8)	10
628-523	240-6-BR	3/8-16	.437	.451	.625	.438 (7/16)	10
628-562	240-M3-BR	M3-0.5	.156	.166	.188	.156 (5/32)	10
628-563	240-M3.5-BR	M3.5-0.6	.187	.199	.250	.188 (3/16)	10
628-564	240-M4-BR	M4-0.7	.218	.230	.313	.219 (7/32)	10
628-565	240-M5-BR	M5-0.8	.250	.262	.375	.250 (1/4)	10
628-566	240-M6-BR	M6-1.0	.312	.326	.500	.313 (5/16)	10



**PRESS INSERTS FOR THERMOSET PLASTICS
BRASS - FLANGED**

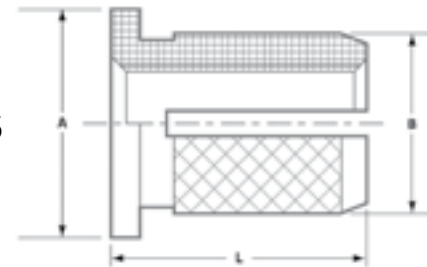

Spaenaur No.	Mfr. No.	Internal Thread	A ±.010"	B ±.010"	L ±.010"	Starting Hole Size	PKG QTY.
628-524	260-002-BR	2-56	.187	.135	.156	.125 (1/8)	10
628-525	260-004-BR	4-40	.218	.166	.188	.156 (5/32)	10
628-B39-1S	260-006-BR	6-32	.249	.199	.250	.188 (3/16)	10
628-527	260-008-BR	8-32	.280	.230	.313	.219 (7/32)	10
628-528	260-332-BR	10-32	.312	.262	.375	.250 (1/4)	10
628-B42-1E	260-4-BR	1/4-20	.375	.326	.500	.313 (5/16)	10
628-B43-1G	260-5-BR	5/16-18	.437	.389	.563	.375 (3/8)	10
628-B44-1W	260-6-BR	3/8-16	.500	.451	.625	.438 (7/16)	10

CATALOG 14

SPAENAUR

Threaded Inserts / Drive Tool

Inserts filetés / Embouts



Inch
Pouce

EZ LOK HEX DRIVE KNIFE THREAD INSERTS (FOR WOOD)

Flanged



Zinc Alloy Die Cast, Zinc Plated

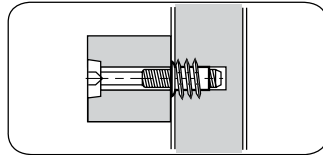

Flush

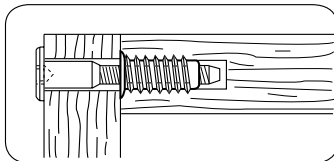
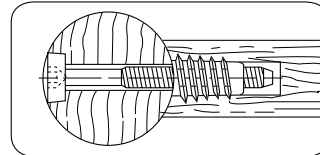

Application for Flanged Insert

Application for Flush Insert

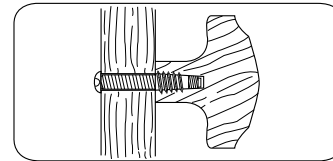

This design can be used to bottom in hole, to be set below surface or on curved surfaces, or to join two components. The head allows user to control depth and to set the insert straight in the material.

The unique tapered external thread design with memory grooves assures positive locking resistance against pull out due to torsion or vibration. High retention values in blind, end and edge grain applications.

(Approximate Inch Measurement)

PKG QTY. 100

SPAENAUR No.	Inside Thread	Head Style	Length	Hole Size	Hex Dimensions	Drive Tool SPAENAUR No.
625-A03-1N	1/4"-20	Flanged	20 mm (3/4")	9 mm (23/64")	6 mm (15/64")	876-B62-1X
625-A05-1S	1/4"-20	Flush	20 mm (3/4")	9 mm (23/64")	6 mm (15/64")	876-B62-1X

Drive Tool



1/4" Hex Drive

PKG QTY. 1

NEW



Threadlocker prevents threaded fasteners from coming loose due to shock and vibration.

See Page B4