

Carriage Bolts / Elevator Bolt Assemblies

Ensembles de boulons de carrosserie et de boulons d'ascenseur

Metric

Métrique



B

METRIC

Carriage Bolts

DIN 603

Regular (Coarse)
METRIC THREAD

ROUND HEAD SQUARE NECK

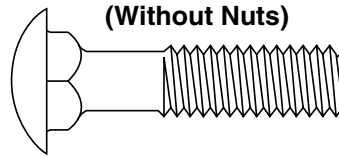

(Without Nuts)
For Metric Hex Nuts, see pages C9 to C15.

18-8
STAINLESS
STEEL

Dia. mm	M6	M8	M10	M12	M16
Pitch mm	1.00	1.25	1.50	1.75	2.00
Lgth. mm	ORDER BY SPAENAUR NUMBERS LISTED BELOW				
25	015-800				
30	015-801	015-807			
40	015-802	015-808	015-813		
50	015-803	015-809	015-814	015-820	015-828
60	015-804	015-810	015-815	015-821	015-829
70	015-805	015-811	015-816	015-822	015-830
80	015-806	015-812	015-817	015-824	015-831
90			015-818	015-824	
100			015-819	015-826	015-832
120				015-827	015-833
25	015-500				
30	015-501	015-507			
50	015-503	015-509		015-520	
60			015-515		
70	015-505	015-511			
80	015-506	015-512	015-517		
90				015-524	
100			015-519		

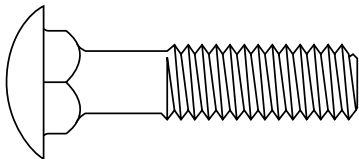

BRASS

Contact Sales Desk For Package Quantities

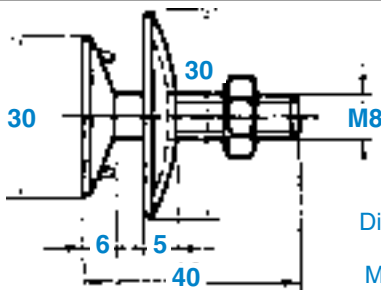

PKG QTY. 50

DIN 15237

SPAENAUR No. 018-100

Metric

Elevator Bolt with Domed Washer and Hex Nut

Property Class 4.6 Steel, Zinc Plated

Regular (COARSE) Metric Thread M8 x 1.25 mm Pitch

See Page B124 for Carriage Bolts





Inch

Elevator Bolts / Step Bolts

Pouce

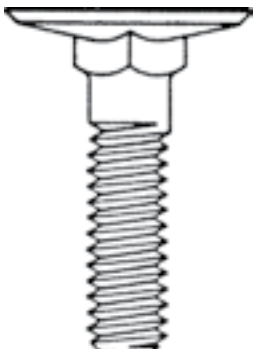
Boulons d'élévateur / Boulons d'échelle

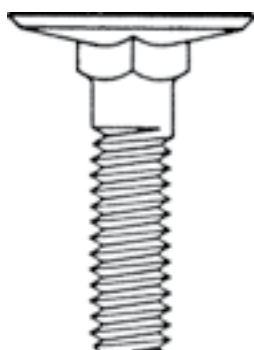
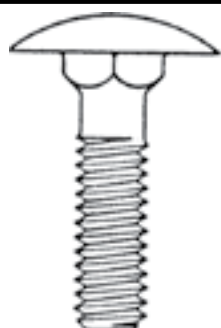
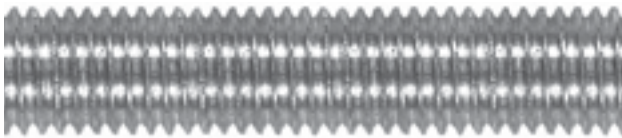
Steel ELEVATOR BOLTS Not Plated		INCH SIZES			
		DIA.	1/4"	5/16"	3/8"
 <p>LARGE HEAD COARSE THREAD (UNC)—2A ASME B18.5</p> <p>◆018-007 Zinc Plated</p>  <p>▲018-101 Fanged Black Finish</p>	THD.	20 UNC	18 UNC	16 UNC	
	Minimum Head Dia.	0.969"	1.188"	1.312"	
	LGTH.	ORDER BY SPAENAUR No.'s BELOW			
	3/4"		018-006 (zinc pltd.)		
	1"	B-1890			100
	1"	▲018-101			100
	1-1/4"	018-005		018-003	100
	1-1/2"	762	B-793	◆018-P02-1X	50
	2"	B-792	018-P01-1M	B-1285	50
	2-1/4"			018-002	50
2-1/2"			018-004	50	
 <p>18-8 Stainless Steel ELEVATOR BOLTS</p> <p>Head & Body Dimensions to ANSI/ASME B18.5</p> <p>LARGE HEAD COARSE THREAD (UNC)—2A ASME B18.5</p>	3/4"	EB-2001			100
	1"	019-A01-2Y	EB-2009		50
	1-1/8"		EB-2010		50
	1-1/4"	019-007	019-A03-1N		50
	1-1/2"	EB-2006	EB-2012	EB-2021	50
	1-1/2"		019-005 (1" head dia.)		50
	2"		EB-2014	019-A02-1C	50
	2-1/4"		EB-2015		50
	2-1/2"		019-001		50
 <p>Steel STEP BOLTS Not Plated</p> <p>COARSE THREAD (UNC)—2A ASME B18.5</p>	DIA.	1/4"	5/16"		PKG QTY.
	THD.	20 UNC	18 UNC		
	Minimum Head Dia.	0.813"	1.000"		
	1-1/4"		018-P03-1A		50
	1-1/2"	761	B-499		50
	2"		B-700		50
	3-1/2"		B-701		50
See Page B286 for Fully Threaded Rods					
					

B