

Carriage Bolts

Boulons de carrosserie



Inch

Pouce

STEEL

LOW CARBON
NOT PLATED

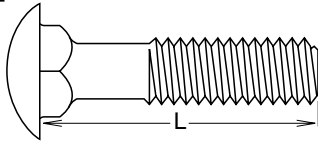

**ROUND HEAD SQUARE NECK
CARRIAGE BOLTS**

ASTM A307
ASME B18.5

MINIMUM THREAD LENGTH
Up to 6" long: Twice dia. plus 1/4"
Over 6" long: Twice dia. plus 1/2"

THREAD CLASS 2A FIT
LENGTH IS MEASURED UNDER
HEAD TO END

B

DIA.	10	1/4"	5/16"	3/8"	7/16"	1/2"	5/8"	3/4"
THD.	24	20	18	16	14	13	11	10
LGTH.	ORDER BY SPAENAU NUMBERS LISTED BELOW							
1/2		CB-53						
3/4	CB-1	CB-4	014-K55-1P					
1	014-K06-1Y	014-K57-1C	014-K52-1M	CB-20	CB-56			
1-1/4	014-K46-1N		014-079					
1-1/2	CB-3	*CB-6	CB-13	CB-21	014-K20-1Y	014-K54-1A		
2		*014-010	*014-025	014-K58-1N	014-K18-1Y	CB-31	014-K60-1N	
2-1/2	014-080	CB-8			CB-43		014-068	
2-1/2		*014-012	*014-026	*014-K51-1W				
3		*014-013	014-K40-1M	CB-24	CB-44	CB-33		
3-1/2			*014-027	*014-032		*014-K49-1W		014-078
4		*014-014	CB-17	CB-25	*014-K44-1Y			
4-1/2				*014-004		014-065		
5		*014-015	*014-028	*014-039	CB-46	014-K31-1P		
6		*014-016	*014-030	CB-27	CB-47	*014-K59-1T		
6-1/2		014-066				014-K50-1K		
7				CB-28				
8				CB-29		CB-38	014-K19-1C	
9						014-K41-1X		
10						CB-39		
11				014-083		014-K47-1T		
12						014-K48-1K		

* Fully Threaded

STEEL - Zinc Plated Fully Threaded

DIA.	8	10	1/4"	5/16"	3/8"	7/16"	1/2"	5/8"
THD.	32	24	20	18	16	14	13	11
LGTH.	ORDER BY SPAENAU NUMBERS LISTED BELOW							
3/8	014-K01-1W							
1/2			014-K13-1W					
5/8	014-K02-1M							
3/4		014-K05-1P	014-181		014-179			
7/8		B-1050						
1			014-154	014-165	014-159			
1-1/4					014-178	CB-40ZP	014-002	
1-1/2		014-K07-1C		014-164	014-163			014-037
1-3/4			014-019		014-162			
2			014-020					
2-1/4			014-183	014-K08-1C				
2-1/2			014-166					
3			014-158					
3-1/2			014-023	014-151				
4			014-024					
5-1/2				CB-52ZP				
6				014-031				
7								014-085

Contact Sales Desk For Package Quantities

B258

© 2018 Spaenaur Inc. All rights reserved. Catalog may not be reproduced, in whole or in part, without the written permission of Spaenaur Inc. Subject to Catalog Terms and Conditions of Use available at Spaenaur.com and on page TC2 and TC3 at the back of this catalog.
© 2018 Spaenaur Inc. Tous droits réservés. Le catalogue ne peut être reproduit, en tout ou en partie, sans l'autorisation écrite de Spaenaur Inc. L'utilisation est soumise aux Conditions d'utilisation du Catalogue disponibles sur Spaenaur.com et à la page TC4 et TC5 à la fin de ce catalogue.

Inch

Pouce



Carriage Bolts

Boulons de carrosserie

STEEL GRADE 5

NOT PLATED

BOLT LENGTH IS MEASURED
UNDER HEAD TO END.

ROUND HEAD SQUARE NECK CARRIAGE BOLTS

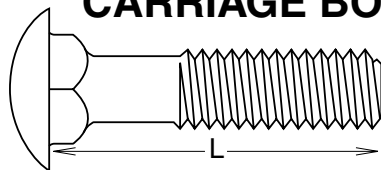

ASTM A307

ASME B18.5

THREAD CLASS 2A FIT

Minimum Thread Length
Up to 6" long: Twice dia. plus 1/4"
Over 6" long: Twice dia. plus 1/2"

DIAMETER	1/4"	5/16"	3/8"	7/16"	1/2"	5/8"	3/4"
THREAD	20	18	16	14	13	11	10
LENGTH	ORDER BY SPAENAUR NUMBERS LISTED BELOW						
5/8"		014-209					
3/4"	014-K14-1M	014-210	014-221				
7/8"		014-211					
1"	014-201	014-212	014-223		014-244		
1-1/4"	*014-202	014-K45-1C	014-K12-1P	014-236	014-245		
1-1/2"	014-203	014-214	014-225	014-237	014-246	014-278	
1-3/4"	014-K56-1Y	014-215	014-226	014-238	014-247	014-253	
2"	014-205	014-216	014-227	014-239	014-K30-1A	014-254	
2-1/4"		014-217	014-228	014-240	014-249	014-255	
2-1/2"	014-207	014-218	014-229	014-241	014-250	014-256	014-269
2-3/4"		014-219	014-K15-1X	014-242	014-251	014-257	
3"		014-220	014-231	014-243	014-252	014-258	014-270
3-1/4"			014-232			014-259	
3-1/2"			014-233			014-260	
4"			014-234			014-261	014-271
4-1/2"						014-262	014-272
5"						014-263	014-273
5-1/2"						014-264	
6"						014-265	014-274
7"						014-266	
8"						014-267	014-276
9"						014-268	

*014-202ZP Zinc Plated

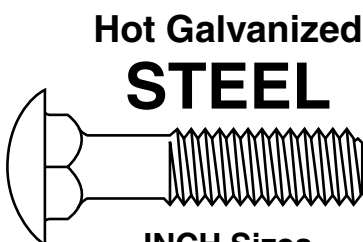

Hot Galvanized STEEL INCH Sizes CARRIAGE BOLTS

MINIMUM THREAD LENGTH
Up to 6" long: Twice dia. plus 1/4"
Over 6" long: Twice dia. plus 1/2"

ASME B18.5

For Galvanized Nuts, see page C6.

(Tapped oversize nuts must be used with galvanized Carriage Bolts.)

DIA.	1/4"	5/16"	3/8"	1/2"	5/8"
THD.	20	18	16	13	11
LENGTH	ORDER BY SPAENAUR NUMBERS LISTED BELOW				
1	014-100	014-110			
1-1/4	014-101	014-111			
1-1/2	014-102	◆014-007	014-K04-1A		
2	014-103			◆014-175	
2-1/2		014-114	◆014-005	◆014-184	
3	014-105	◆014-006	014-123		014-K16-1A
3-1/2			◆014-186	014-K09-1T	
4	014-107	014-117	014-125	◆014-022	
5	014-108	◆014-009	014-K42-1A	014-137	
6	◆014-185	014-119	014-127	014-138	
6-1/2			014-128		
7			014-129	014-139	
8			014-130	014-140	014-146
10			014-131	014-141	014-147

Contact Sales Desk For Package Quantities

◆ Fully Threaded

CATALOG 14

SPAENAUR

Carriage Bolts / Square Head Bolts

Boulons de carrosserie / Boulons à tête carrée

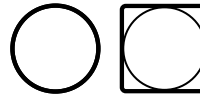

Inch
Pouce

**STAINLESS
STEEL 18-8**

Head & Body Dimensions to ANSI/ASME B18.5
Rockwell Hardness Min. B70

Carriage Bolt

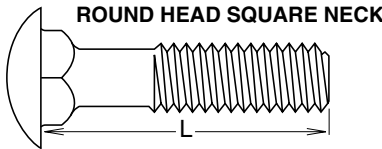

**THREAD CLASS
2A FIT**

MINIMUM THREAD LENGTH:
Up to 6" long: Twice dia. plus 1/4"
Over 6" long: Twice dia. plus 1/2"
Length shown is under head to end in inches.

DIA.	1/4"	5/16"	3/8"	1/2"	5/8"
THD.	20	18	16	13	11
LGTH.	ORDER BY SPAENAU NUMBERS LISTED BELOW				
1/2	014-800				
3/4	014-801	014-K29-1P	014-821		
1	014-K21-1C	014-K28-1A	014-K33-1C	014-833	
1-1/4	014-K27-1X	014-813	014-K34-1N		
1-1/2	014-804	014-814	014-824	014-K10-1P	
1-3/4	014-805	014-815	014-825		
2	014-K26-1M	014-816	014-826	014-835	
2-1/4		014-817			
2-1/2	014-K38-1M	014-K39-1X	014-827	014-836	
3	014-K36-1K	014-K53-1X	014-828	014-K11-2T	
3-1/2	014-K37-1W	014-K32-1Y	014-829	014-K25-1W	
4	014-K24-1K		014-K22-1N	014-839	014-K03-1X 014-K43-1P
4-1/2			014-K23-1T	014-840	
5					
6			014-832	014-K35-1T	
Contact Sales Desk For Package Quantities					

For Nuts See
Pages C2 to C15

STEEL Square Head Bolt

LOW CARBON / HEAT TREATED / STRESS RELIEVED

MINIMUM TENSILE STRENGTH (PSI)

All sizes 55,000 PSI.

Length shown is under head to end in inches.



NOT PLATED

ASTM A307

MINIMUM THREAD LENGTH:
Up to 6" long: Twice dia. plus 1/4"
Over 6" long: Twice dia. plus 1/2"

COARSE THREAD (U.N.C. - U.S.S.)						UNIFIED STANDARD CLASS 2A FIT (NOT AVAILABLE IN FINE THREAD)
DIA.	1/4"	5/16"	3/8"	1/2"	5/8"	3/4"
THD.	20	18	16	13	11	10
LGTH.	ORDER BY SPAENAU NUMBERS LISTED BELOW					
3/4	042-H02-1C	MB-826				
1		MB-827	MB-832	MB-841		
1-1/4			MB-833			
1-1/2		042-H04-1T		MB-801		
2	MB-823	MB-829	042-H03-1N	042-H05-1K	MB-814	MB-844
2-1/2	MB-824	MB-806		MB-842	MB-853	042-H01-1Y
3				042-H07-1M	MB-815	MB-845
3-1/2		MB-851	MB-852	042-006		
4				042-H06-1W	042-H08-1X	MB-846
4-1/2				042-005		
5					MB-817	
5-1/2				042-004		

Contact Sales Desk For Package Quantities

For Nuts See
Pages C2 to C15

Metric
Métrique



Carriage Bolt Assemblies
Ensembles de boulons de carrosserie

DIN 603-Mu
ROUND HEAD
SQUARE NECK
Carriage Bolt
with Hex Nut

Property Class 3.6 or 4.6 Steel
(Our Option)
Plain Finish

Regular (Coarse)
METRIC THREAD

Tensile strength Rm: min. **400 N/mm²**
58000 psi



B

Dia. mm	M5	M6	M8	M10	M12	M16
Pitch mm	0.8	1.00	1.25	1.50	1.75	2.00
Lgth. mm	ORDER BY SPAENAUR NUMBERS LISTED BELOW					
16	015-050	015-063	015-079			
20	015-051	015-064	015-080	015-095		
25	015-052	015-065	015-081	015-096		
30	015-053	015-066	015-082	015-097	015-T01-1P	
35	015-054	015-067	015-083	015-098	015-113	
40	*015-055	015-068	015-084	015-099	015-114	015-137
45	015-056	015-069	015-085	015-100	015-115	015-138
50	015-057	015-070	015-086	015-101	015-116	015-139
55		015-071	015-087	015-102	015-117	015-140
60	015-059	015-072	015-088	015-103	015-118	015-141
65	015-060	015-073	015-089	015-104	015-119	015-142
70	015-061	015-074	015-090	015-105	015-120	015-143
75				015-106	015-121	015-144
80		015-076	015-092	015-107	015-122	015-145
90		015-077	015-093	015-108	015-123	015-146
100		015-078	015-094	015-109	015-124	015-147
110				015-110	015-125	015-148
120				015-111	015-126	
130					015-127	015-150
140					015-128	015-151
150					015-129	015-152
160					015-130	015-153
170				(Zinc Plated)	015-131	015-154
180					015-132	015-155
190					015-133	015-156
200					015-134	015-157
*015-055ZP Zinc Pltd. 015-080ZP Zinc Pltd. 015-071ZP Zinc. Pltd. 015-145ZP Zinc Pltd. 015-098ZP Zinc. Pltd.						

Contact Sales Desk For Package Quantities

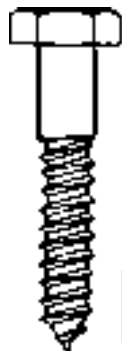

STEEL
LAG SCREWS
HEXAGON HEAD

For Lag Screws See Page B257

CATALOG 14
SPAENAUR

More Metric Carriage Bolts on following page

Carriage Bolts / Elevator Bolt Assemblies

Ensembles de boulons de carrosserie et de boulons d'ascenseur

Metric

Métrique



B

METRIC

Carriage Bolts

DIN 603

Regular (Coarse)
METRIC THREAD

ROUND HEAD SQUARE NECK

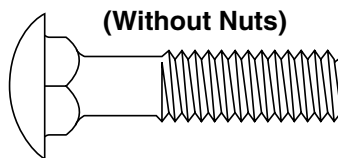

(Without Nuts)
For Metric Hex Nuts, see pages C9 to C15.

18-8
STAINLESS
STEEL

Dia. mm	M6	M8	M10	M12	M16
Pitch mm	1.00	1.25	1.50	1.75	2.00
Lgth. mm	ORDER BY SPAENAUR NUMBERS LISTED BELOW				
25	015-800				
30	015-801	015-807			
40	015-802	015-808	015-813		
50	015-803	015-809	015-814	015-820	015-828
60	015-804	015-810	015-815	015-821	015-829
70	015-805	015-811	015-816	015-822	015-830
80	015-806	015-812	015-817	015-824	015-831
90			015-818	015-824	
100			015-819	015-826	015-832
120				015-827	015-833
25	015-500				
30	015-501	015-507			
50	015-503	015-509		015-520	
60			015-515		
70	015-505	015-511			
80	015-506	015-512	015-517		
90				015-524	
100			015-519		

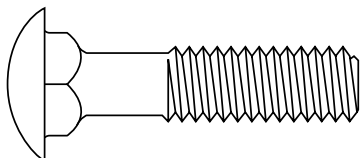

BRASS

Contact Sales Desk For Package Quantities

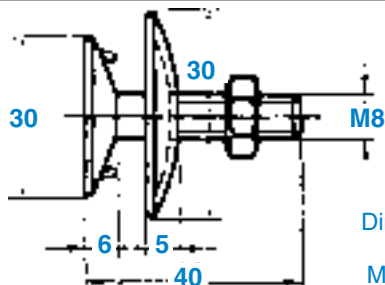

PKG QTY. 50

DIN 15237

SPAENAUR No. 018-100

Metric

Elevator Bolt with Domed Washer and Hex Nut

Property Class 4.6 Steel, Zinc Plated

Regular (COARSE) Metric Thread M8 x 1.25 mm Pitch

See Page B124 for Carriage Bolts

