

Rings / Pliers

Inch

Bagues / Pincés

Pouce

**SPLIT RINGS**

DIMENSION "A"



DIMENSION "B"

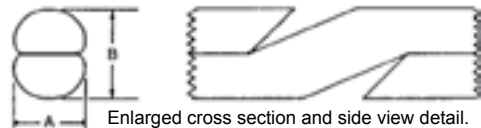

Enlarged cross section and side view detail.

Available in  
**TEMPERED**  
**STEEL**  
and  
**BRASS**

**OUTSIDE DIA. TOLERANCES:**

Up to .875" Outside Dia.  
Steel +.015 to -.005  
Brass +.025 to -.005  
.  
.875" and up Outside Dia.  
+.115 to -.005

**Steel**  
**Nickel Plated**

SPAENAUR No.	Material	Finish	Outside Dia.	Inside Dia.	"A" ± .005	"B" ± .005	SPAENAUR No.
MH-99	Steel	Zinc	.220"	.162"	.029"	.040"	121-033
MH-100	Steel	Zinc	.254"	.192"	.031"	.046"	121-034
MH-101	Steel	Zinc	.292"	.222"	.035"	.054"	121-035
MH-102	Steel	Zinc	.334"	.264"	.035"	.054"	121-036
MH-103	Steel	Zinc	.380"	.300"	.040"	.062"	121-037
MH-103B	Brass	Nickel	.380"	.300"	.040"	.062"	—
MH-104	Steel	Zinc	.430"	.328"	.051"	.074"	121-038
121-C69-1T	Steel	Zinc	.484"	.382"	.051"	.074"	121-039
MH-106	Steel	Zinc	.542"	.428"	.057"	.083"	121-040
121-168	Steel	Zinc	.604"	.460"	.072"	.105"	121-041
121-195	Brass	Nickel	.670"	.526"	.072"	.105"	—
MH-189	Steel	Zinc	.740"	.596"	.072"	.105"	121-042
121-194	Brass	Nickel	.740"	.596"	.072"	.105"	—
121-196	Brass	Plain	.740"	.596"	.072"	.105"	—
121-159	Steel	Zinc	.875"	.707"	.084"	.110"	121-043
121-C41-1P	Steel	Zinc	.970"	.802"	.084"	.110"	121-044
121-161	Steel	Zinc	1.250"	1.062"	.094"	.130"	121-045
MH-94	Steel	Zinc	1.375"	1.159"	.108"	.142"	121-046
MH-95	Steel	Zinc	1.480"	1.264"	.108"	.142"	121-047
MH-96	Steel	Zinc	1.640"	1.396"	.122"	.168"	121-C36-1M

PKG QTY. 100 ALL SIZES EXCEPT MH-96 PKG QTY. 50

**SPLIT RING PLIERS**

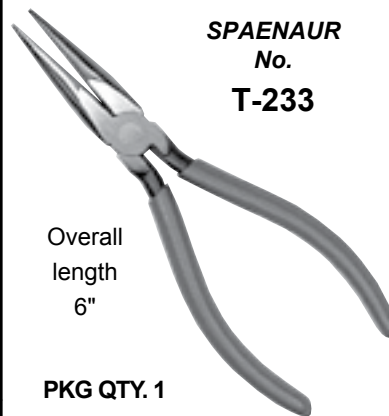

**SPAENAUR**  
**No.**  
**T-233**

Overall length  
6"

PKG QTY. 1

A specially designed plier for easy and speedy assembly of Split Rings to articles of all types.



**SPAENAUR**  
**No.**  
**876-497**

Zinc Plated  
STEEL

Overall length  
5-1/8"

PKG QTY. 1

A special utility tool designed exclusively for assembling or removing small split rings.

M

**HINGED STEEL RING**



Nickel Plated



For loose-leaf binders

PKG QTY. 100

SPAENAUR No.	I.D.	Wire Dia.
121-003	3/4"	.095"
MH-148	1"	.121"
121-004	1-1/4"	.116"
121-002	1-1/2"	.116"
121-005	2"	.130"
121-007	3"	.171"

**TAG RINGS**

Steel Zinc Plated  
Steel Tinned Wire

SPAENAUR No. 121-C62-1M



ROUND

**I.D.**      **O.D.**  
11/16"      3/4"

PKG QTY. 1,000

Useful for holding tags to loops or as an inexpensive key ring.

For blank Tags and Name Plates See page P92.

Inch

Rings / Loops / Hooks / Eyes / Buckle Slides

Pouce

Anneaux / Boucles / Crochets / Yeux / Glissières à boucle

**ROUND RINGS**

STEEL WIRE - NICKEL PLATED

ABUTTED JOINT



SPAENAUR No.	I.D.	Wire Dia.	PKG QTY.
MH-17	1/2"	.120"	100
121-C35-1W	5/8"	.120"	100
121-200	3/4"	.177"	100
MH-24	1-1/2"	.160"	100
121-018	2"	.250"	50



**ROUND RINGS  
PLATED STEEL**

(Nickel or Zinc - Our option.)

WELDED JOINT

SPAENAUR No.	Inside Dia.	Wire Gauge	PKG QTY.
121-008	1"	.177"	100
121-C32-1N	1-1/4"	7/32"	50
MH-38	1-1/2"	1/4"	50
MH-39	1-3/4"	1/4"	50
MH-40	2"	1/4"	50
MH-41	2-1/2"	1/4"	50
MH-42	3"	5/16"	25



**TUCK LOOP**

Steel Wire  
Nickel Plated

SPAENAUR No.	Inside Width	Inside Height	Wire Dia.
MH-121	5/8"	3/8"	.105"
MH-122	3/4"	3/8"	.105"
121-C61-1W	1"	7/16"	.113"
MH-127	1-1/2"	1/2"	.120"
MH-128	2"	1/2"	.148"

PKG QTY. 100

SPAENAUR No.  
**121-176**

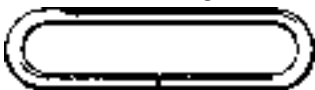

PKG QTY. 100

**STEEL WIRE LOOP**

NICKEL PLATED  
FOR 1-1/16" STRAP  
O/S 21/64" x 1-15/64" x .080"

**FOOTMAN LOOPS**

Steel - Zinc Plated



SPAENAUR No.	For Strap Size	Screw Hole Dia.	Screw Holes c. to c.	PKG QTY.
▲121-C66-1Y	1"	3/16"	1-15/16"	100
121-C38-1A	2"	1/4"	3-1/8"	100

▲ CAD plated



UH-81  
HOOK

PKG QTY. 100

**HOOKS  
and  
EYES**

For Headbands  
(used with 1/2" webbing)

Steel — Nickel Plated



UH-82  
EYE

PKG QTY. 100

**SLIDES (Webbing Adjuster Buckles)**



SPAENAUR No. **121-C59-1W**

Sheet Steel - 3/32" Thick  
For 2" wide webbing Slot width 3/16"  
Size overall 7/8" x 2-3/8"  
Nickel Plated Finish

PKG QTY. 50



**SLIDES**

NICKEL PLATED  
SHEET STEEL

Approx. .050" Thick

SPAENAUR No.	L LENGTH OF SLOT	W WIDTH OF SLOT	A OVER-ALL LENGTH	B OVER-ALL WIDTH	PKG QTY.
121-013	5/8"	3/16"	7/8"	11/16"	100
121-014	3/4"	3/16"	1"	11/16"	100

**Metal "Dee" Rings / Clips / Anchor Plate / Buckles**

Inch

**Anneaux / Clips / Anchor Plate / Buckles en métal "Dee"**

Pouce

**DEE RINGS**

STEEL WIRE  
NICKEL PLATED

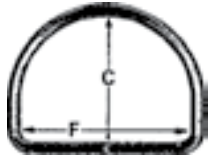

**ABUTTED JOINT**

SPAENAUR No.	F (Flat)	C (Crown)	Wire Dia.	PKG QTY.
121-010	5/8"	7/16"	.080"	100
MH-6	5/8"	7/16"	.120"	100
MH-7	3/4"	5/8"	.120"	100
■ 121-026	3/4"	5/8"	.120"	100
*MH-4	3/4"	5/8"	.120"	100
MH-8	7/8"	3/4"	.148"	100
MH-9	1"	7/8"	.120"	100
▲ 121-807	1"	7/8"	.125"	100
MH-10	1-1/8"	7/8"	.120"	100
◆ 121-349	1-1/8"	7/8"	.142"	50
121-011	1-1/8"	7/8"	.177"	100
MH-11	1-5/16"	1"	.148"	100
MH-12	1-5/8"	1-1/8"	.177"	100
MH-13	2"	1-3/8"	.160"	50

◆ Welded Joint \*Brass Plated ▲ 304 Stainless Steel ■ Plain Finish



**"D" RING CLIP**

Sheet Steel—Nickel Plated

SPAENAUR No.	Width	O/A Lgth.
MH-135	5/8"	13/16"
MH-136	3/4"	13/16"

PKG QTY. 100



**"D" RING ANCHOR PLATE**

Sheet Steel—Nickel Plated

SPAENAUR No.	11/16" Width x 1-3/8" Length	3/16" Dia. holes - 27/32" C. to C.	Eye diameter 1/8"
121-198			

PKG QTY. 100

**BUCKLES**

Centre Bar Type

Sheet Steel Nickel Plated



SPAENAUR No.	Width	PKG QTY.
MH-116	1/2"	100
MH-117	5/8"	100

Zinc Die Cast Nickel Plated

121-116	1/2"	100
121-117	3/4"	100
121-118	1"	100

**HEAVY WEIGHT DEE**

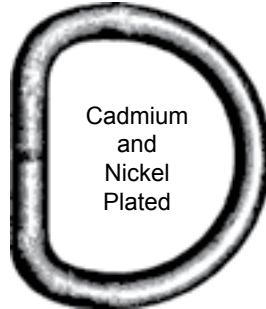

Cadmium and Nickel Plated

PKG QTY. 50

WELDED STEEL WIRE

SPAENAUR No.	Inside Width	Wire Dia.
Cad or Zinc (our option)		
121-C34-1K	1"	.207"
121-C64-1A	1-1/4"	.243"
MH-49	2"	.312"

Zinc Plated

MH-45	1-1/8"	.207"
MH-47	1-1/2"	.250"
121-351	2"	.262"

Nickel Plated

121-253	15/16"	.160"
121-255	1-5/16"	.207"
121-358	1-3/4"	.250"
MH-48	1-3/4"	.262"

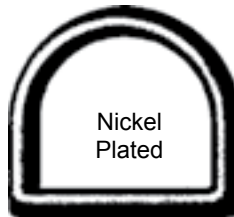

Nickel Plated

PKG QTY. 100

**DEE**

CAST SOLID BRASS

SPAENAUR No.	Inside Width	Inside Height
MH-36	1"	13/16"



**CLIP AND DEE**

Steel Wire Dee with Sheet Steel Clip Nickel Plated

SPAENAUR No.	Clip Width	O/A Lgth.	Hole Dia.	PKG QTY.
121-C58-1K	3/4"	1-3/8"	.201"	100
*121-809	1-1/8"	2-27/32"	.375"	10

\*All Stainless Steel 300 Series



PKG QTY. 25

**Welded Steel TRIANGLE LOOP**  
Nickel Plated

SPAENAUR No.	121-332
Max. Inside Width 1-1/2"	
Wire Dia. .150"	

M

Inch

**Hooks / Shower Curtain Rings**

Pouce

Crochets / Anneaux pour rideaux de douche

**"S" HOOK**  
Zinc Plated STEEL



SPAENAUR No.	Wire Dia.	Lgth. O/A	PKG QTY.
*121-C65-1P	.102"	1"	100
MH-75	.141"	1-1/2"	25
MH-77	.185"	2-1/4"	25
MH-79	.272"	2-3/4"	25
121-090	.312"	3"	25
MH-74	.375"	3-1/4"	25
121-091	.375"	3-1/2"	25

(\*Plain Brass)

SPAENAUR No. N-129H

**MOLLY HOOK**

Steel – Zinc Plated

**FOR PICTURES, MIRRORS, ETC.**

It is neat in appearance and sturdily constructed to hold pictures, mirrors, etc. The hole will accommodate a 6-32 screw such as used with Jacknut No. N-125.

For use with larger screws, the hole may be enlarged easily by removing the insert.

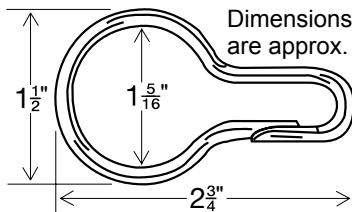

Dimensions are approx.

**METAL SHOWER CURTAIN RING**

SPAENAUR No. 121-C67-1C

Steel, Zinc or Nickel plated, our option.

PKG QTY. 50

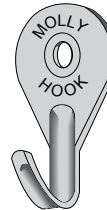

Actual Size

PKG QTY. 50

# Hooks

Both Hooks are 3/16" dia. Steel Wire, Zinc Plated.

SPAENAUR No.	Height	Projection	Holes Centre to Centre	Use Screws	PKG QTY.
099-191	2-5/8"	1-5/8"	3/4"	2 #9 Round Hd.	10
099-192	2-1/4"	3-3/8"	7/8"	2 #10 Round Hd.	10

**099-191**

Single Costumer Hook

Side Mount

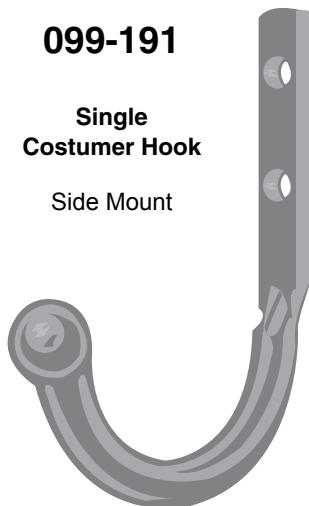

Top Mount

**099-192**

Double Costumer Hook

Welded together

