

Joint Connector Bolts / Nuts

Boulons d'assemblage / Écrous



Inch
Pouce

JOINT CONNECTOR BOLT

STEEL - Bronze Plated
Decorative Head

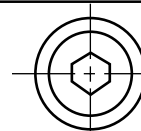
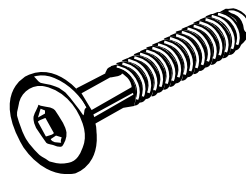

Hex Drive
M4

Low profile, high quality, decorative head bolt designed to connect components at right angles or parallel.

Hanger Bolts on Page B60

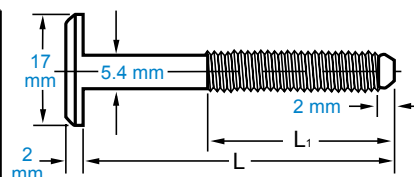
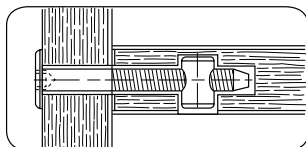
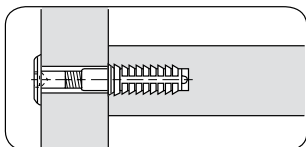

SPAENAUR No.	Thread Size	L	L1	PKG QTY.
191-450	1/4"-20	1.969" (50 mm)	1.181" (30 mm)	50
191-451	1/4"-20	2.362" (60 mm)	1.575" (40 mm)	50
191-452	1/4"-20	2.756" (70 mm)	1.575" (40 mm)	50

JOINT CONNECTOR BOLT

STEEL - Bronze Plated
Decorative Head with Shoulder

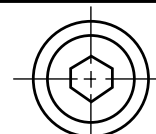
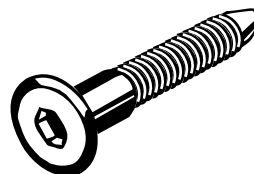

Hex Drive
M5

Low profile, high quality, decorative head bolt designed to connect components at right angles or parallel. Shoulder is the same diameter as the joint connector nut to allow through hole connection.

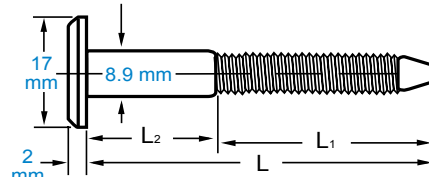
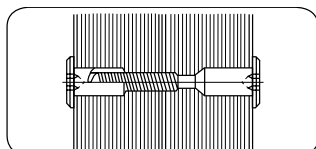
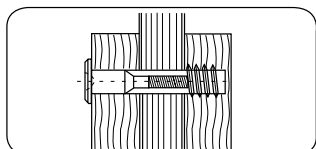

SPAENAUR No.	Thread Size	L	L1	L2	PKG QTY.
*191-456	1/4"-20	1.575" (40 mm)	Full Thread	.394" (10 mm)	50
191-453	1/4"-20	1.969" (50 mm)	Full Thread	.709" (18 mm)	50
191-454	1/4"-20	2.362" (60 mm)	1.378" (35 mm)	.709" (18 mm)	50
191-455	1/4"-20	2.756" (70 mm)	1.378" (35 mm)	.709" (18 mm)	50

*Black Oxide

JOINT CONNECTOR NUT

STEEL - Bronze Plated
Decorative Nut

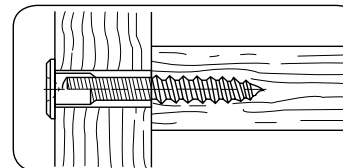
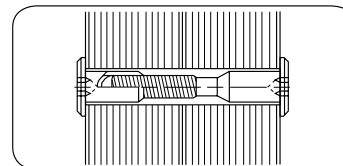

Low Profile, high quality, decorative, cold headed, steel cap. Matches finish and dimensions for use with Joint Connector Bolt.

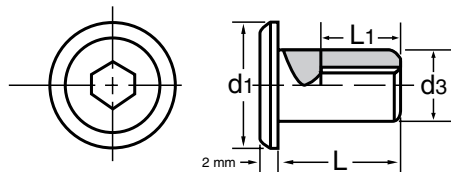

SPAENAUR No.	Thread Size	L	L1	d1	d3	Hex Drive	PKG QTY.
191-400	1/4"-20	.472" (12 mm)	.315" (8 mm)	.669" (17 mm)	.350" (9 mm)	5 mm	100
191-401	1/4"-20	.669" (17 mm)	.512" (13 mm)	.669" (17 mm)	.350" (9 mm)	5 mm	100

Also see T-Nuts page C58-C61.

Many other styles, sizes and lengths available special to order. We welcome your inquiry.