

**Torque Wrenches / Tool Kit / Torque Screwdriver**

**Clés dynamométriques / Trousse d'outils / Tournevis dynamométrique**



Inch and Metric  
Pouce et Métrique

**Torque Wrenches**

DBP

DIN/ISO 6789

With reversible ratchet

drive as per DIN 3120

Release accuracy tolerance:

± 2% of values selected

at right hand threads,

with locking knob for extra retention of torque setting



SPAENAUR No.	HAZET No.	■	Nm Torque range	L mm
◆ 992-938	6110-1 CT	3/8"	10-60	335
◆ 992-939	6111-1 CT	3/8"	20-120	389
◆ 992-940	6121-1 CT	1/2"	20-120	435
◆ 992-941	6122-1 CT	1/2"	40-200	545
◆ 992-942	6123-1 CT	1/2"	60-320	663
● 992-943	6143-1 CT	3/4"	100-400	803
● 992-945	6145-1 CT	3/4"	300-800	1280

◆ = in Safe Box

● = without signal transmitter

**Torque Wrenches**

DBP

To US Standards

With scale graduation in foot/pounds

Release accuracy tolerance:

± 3% of values selected

at right hand threads,

with locking knob for extra retention of torque setting



SPAENAUR No.	HAZET No.	■	B		T		L mm
			ft./lbs.	Nm	ft./lbs.	Nm	
◆ 992-953	6115-1 CT	3/8"	20-100	27.1-135.6	1/2	0.7	390
◆ 992-954	6127-1 CT	1/2"	40-200	54.3-270	1	1.4	545

B = Torque Range

T = Graduation

◆ = in Safe-Box



**Tool Kit, empty**

Made from sheet steel

5 trays, with padlock

Length 575 mm

Width 210 mm

Height 245 mm

**SPAENAUR No. 990-089**

(HAZET No. 190 L)

Blue

Store enamelled



**Torque Screwdriver SYSTEM 6000 CT**

With automatic close-gap release, palpable and audible when torque setting is reached.

Release accuracy tolerance:

± 5% of values selected

Tightening at torque setting

is possible both to the

right and left,

with micrometer adjustment

by simply turning the red ring (1)

and the handle at the same

time (2), scale value will be

locked automatically after

releasing the red ring (3).

With 1/4" inside hexagon drive for screwdriver bits

With 1/4" outside hexagon drive

Torque Range		Increase/Turn		Graduation	
cNm	Nm	cNm	Nm	cNm	Nm
10-120	—	10	—	1	—
—	1-6	—	1	—	0.1



SPAENAUR No.	HAZET No.	⬡	cNm	Nm	L mm
992-931	6002 CT	1/4"	10-120	—	170
992-932	6003 CT	1/4"	—	1-6	230

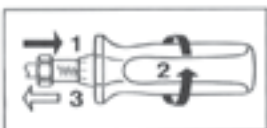

N