

**Carriage Bolts**

**Boulons de carrosserie**



Inch

Pouce

**STEEL**

LOW CARBON  
NOT PLATED

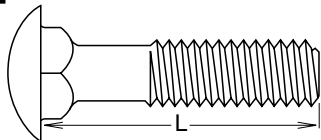

**ROUND HEAD SQUARE NECK  
CARRIAGE BOLTS**

ASTM A307

ASME B18.5

**MINIMUM THREAD LENGTH**  
Up to 6" long: Twice dia. plus 1/4"  
Over 6" long: Twice dia. plus 1/2"

**THREAD CLASS 2A FIT**  
LENGTH IS MEASURED UNDER  
HEAD TO END

**B**

DIA.	10	1/4"	5/16"	3/8"	7/16"	1/2"	5/8"	3/4"
THD.	24	20	18	16	14	13	11	10
LGTH.	<b>ORDER BY SPAENAUR NUMBERS LISTED BELOW</b>							
1/2		CB-53						
3/4	CB-1	CB-4	014-K55-1P					
1	014-K06-1Y	014-K57-1C	014-K52-1M	CB-20	CB-56			
1-1/4	014-K46-1N		014-079					
1-1/2	CB-3	*CB-6	CB-13	CB-21	014-K20-1Y	014-K54-1A		
2		*014-010	*014-025	014-K58-1N	014-K18-1Y	CB-31	014-K60-1N	
2-1/2	014-080	CB-8			CB-43		014-068	
2-1/2		*014-012	*014-026	*014-K51-1W				
3		*014-013	014-K40-1M	CB-24	CB-44	CB-33		
3-1/2			*014-027	*014-032		*014-K49-1W		014-078
4		*014-014	CB-17	CB-25	*014-K44-1Y			
4-1/2				*014-004		014-065		
5		*014-015	*014-028	*014-039	CB-46	014-K31-1P		
6		*014-016	*014-030	CB-27	CB-47	*014-K59-1T		
6-1/2		014-066				014-K50-1K		
7				CB-28				
8				CB-29		CB-38	014-K19-1C	
9						014-K41-1X		
10						CB-39		
11				014-083		014-K47-1T		
12						014-K48-1K		

\* Fully Threaded

**STEEL - Zinc Plated Fully Threaded**

DIA.	8	10	1/4"	5/16"	3/8"	7/16"	1/2"	5/8"
THD.	32	24	20	18	16	14	13	11
LGTH.	<b>ORDER BY SPAENAUR NUMBERS LISTED BELOW</b>							
3/8	014-K01-1W							
1/2			014-K13-1W					
5/8	014-K02-1M							
3/4		014-K05-1P	014-181		014-179			
7/8		B-1050						
1			014-154	014-165	014-159			
1-1/4					014-178	CB-40ZP	014-002	
1-1/2		014-K07-1C		014-164	014-163			014-037
1-3/4			014-019		014-162			
2			014-020					
2-1/4			014-183	014-K08-1C				
2-1/2			014-166					
3			014-158					
3-1/2			014-023	014-151				
4			014-024					
5-1/2				CB-52ZP				
6				014-031				
7								014-085

Contact Sales Desk For Package Quantities

Inch

Pouce



Carriage Bolts

Boulons de carrosserie

# STEEL GRADE 5

NOT PLATED

BOLT LENGTH IS MEASURED  
UNDER HEAD TO END.

## ROUND HEAD SQUARE NECK CARRIAGE BOLTS

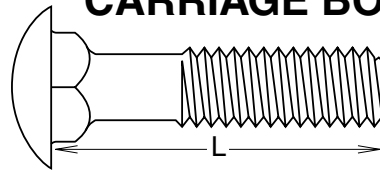

ASTM A307

ASME B18.5

THREAD CLASS 2A FIT

Minimum Thread Length  
Up to 6" long: Twice dia. plus 1/4"  
Over 6" long: Twice dia. plus 1/2"

DIAMETER	1/4"	5/16"	3/8"	7/16"	1/2"	5/8"	3/4"
THREAD	20	18	16	14	13	11	10
LENGTH	ORDER BY SPAENAUR NUMBERS LISTED BELOW						
5/8"		014-209					
3/4"	014-K14-1M	014-210	014-221				
7/8"		014-211					
1"	014-201	014-212	014-223		014-244		
1-1/4"	*014-202	014-K45-1C	014-K12-1P	014-236	014-245		
1-1/2"	014-203	014-214	014-225	014-237	014-246	014-278	
1-3/4"	014-K56-1Y	014-215	014-226	014-238	014-247	014-253	
2"	014-205	014-216	014-227	014-239	014-K30-1A	014-254	
2-1/4"		014-217	014-228	014-240	014-249	014-255	
2-1/2"	014-207	014-218	014-229	014-241	014-250	014-256	014-269
2-3/4"		014-219	014-K15-1X	014-242	014-251	014-257	
3"		014-220	014-231	014-243	014-252	014-258	014-270
3-1/4"			014-232			014-259	
3-1/2"			014-233			014-260	
4"			014-234			014-261	014-271
4-1/2"						014-262	014-272
5"						014-263	014-273
5-1/2"						014-264	
6"						014-265	014-274
7"						014-266	
8"						014-267	014-276
9"						014-268	

\*014-202ZP Zinc Plated

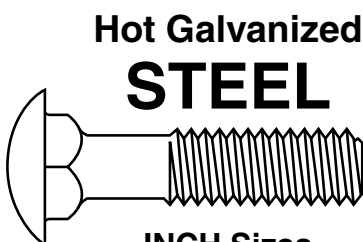

## Hot Galvanized STEEL INCH Sizes CARRIAGE BOLTS

MINIMUM THREAD LENGTH  
Up to 6" long: Twice dia. plus 1/4"  
Over 6" long: Twice dia. plus 1/2"

ASME B18.5

For Galvanized Nuts, see page C6.

(Tapped oversize nuts must be used with galvanized Carriage Bolts.)

DIA.	1/4"	5/16"	3/8"	1/2"	5/8"
THD.	20	18	16	13	11
LENGTH	ORDER BY SPAENAUR NUMBERS LISTED BELOW				
1	014-100	014-110			
1-1/4	014-101	014-111			
1-1/2	014-102	◆014-007	014-K04-1A		
2	014-103			◆014-175	
2-1/2		014-114	◆014-005	◆014-184	
3	014-105	◆014-006	014-123		014-K16-1A
3-1/2			◆014-186	014-K09-1T	
4	014-107	014-117	014-125	◆014-022	
5	014-108	◆014-009	014-K42-1A	014-137	
6	◆014-185	014-119	014-127	014-138	
6-1/2			014-128		
7			014-129	014-139	
8			014-130	014-140	014-146
10			014-131	014-141	014-147

Contact Sales Desk For Package Quantities

◆ Fully Threaded

**Carriage Bolts / Square Head Bolts**

Boulons de carrosserie / Boulons à tête carrée



Inch

Pouce

**STAINLESS STEEL 18-8**

Head & Body Dimensions to ANSI/ASME B18.5  
Rockwell Hardness Min. B70

**Carriage Bolt**

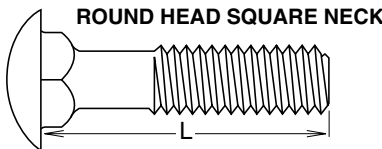

**THREAD CLASS 2A FIT**

**MINIMUM THREAD LENGTH:**  
Up to 6" long: Twice dia. plus 1/4"  
Over 6" long: Twice dia. plus 1/2"  
Length shown is under head to end in inches.

**B**

DIA.	1/4"	5/16"	3/8"	1/2"	5/8"
THD.	20	18	16	13	11
LGTH.	<b>ORDER BY SPAENAUR NUMBERS LISTED BELOW</b>				
1/2	014-800				
3/4	014-801	014-K29-1P	014-821		
1	014-K21-1C	014-K28-1A	014-K33-1C	014-833	
1-1/4	014-K27-1X	014-813	014-K34-1N		
1-1/2	014-804	014-814	014-824	014-K10-1P	
1-3/4	014-805	014-815	014-825		
2	014-K26-1M	014-816	014-826	014-835	
2-1/4		014-817			
2-1/2	014-K38-1M	014-K39-1X	014-827	014-836	
3	014-K36-1K	014-K53-1X	014-828	014-K11-2T	
3-1/2	014-K37-1W	014-K32-1Y	014-829	014-K25-1W	
4	014-K24-1K		014-K22-1N	014-839	014-K03-1X 014-K43-1P
4-1/2					
5			014-K23-1T	014-840	
6			014-832	014-K35-1T	
Contact Sales Desk For Package Quantities					

For Nuts See  
Pages C2 to C15

**STEEL Square Head Bolt**

LOW CARBON / HEAT TREATED / STRESS RELIEVED

MINIMUM TENSILE STRENGTH (PSI)

All sizes 55,000 PSI.

Length shown is under head to end in inches.



NOT PLATED

**ASTM A307**

**MINIMUM THREAD LENGTH:**  
Up to 6" long: Twice dia. plus 1/4"  
Over 6" long: Twice dia. plus 1/2"

<b>COARSE THREAD (U.N.C. - U.S.S.)</b>						UNIFIED STANDARD CLASS 2A FIT (NOT AVAILABLE IN FINE THREAD)
DIA.	1/4"	5/16"	3/8"	1/2"	5/8"	3/4"
THD.	20	18	16	13	11	10
LGTH.	<b>ORDER BY SPAENAUR NUMBERS LISTED BELOW</b>					
3/4	042-H02-1C	MB-826				
1		MB-827	MB-832	MB-841		
1-1/4			MB-833			
1-1/2		042-H04-1T		MB-801		
2	MB-823	MB-829	042-H03-1N	042-H05-1K	MB-814	MB-844
2-1/2	MB-824	MB-806		MB-842	MB-853	042-H01-1Y
3				042-H07-1M	MB-815	MB-845
3-1/2		MB-851	MB-852	042-006		
4				042-H06-1W	042-H08-1X	MB-846
4-1/2				042-005		
5					MB-817	
5-1/2				042-004		

Contact Sales Desk For Package Quantities

For Nuts See  
Pages C2 to C15

Metric

Métrique



Carriage Bolt Assemblies

Ensembles de boulons de carrosserie

**DIN 603-Mu**  
**ROUND HEAD**  
**SQUARE NECK**  
**Carriage Bolt**  
 with Hex Nut

Property Class 3.6 or 4.6 Steel  
 (Our Option)  
**Plain Finish**  
**Regular (Coarse)**  
**METRIC THREAD**  
 Tensile strength Rm: min. **400 N/mm<sup>2</sup>**  
 58000 psi



**B**

Dia. mm	M5	M6	M8	M10	M12	M16
Pitch mm	0.8	1.00	1.25	1.50	1.75	2.00
Lgth. mm	<b>ORDER BY SPAENAUR NUMBERS LISTED BELOW</b>					
16	015-050	015-063	015-079			
20	015-051	015-064	015-080	015-095		
25	015-052	015-065	015-081	015-096		
30	015-053	015-066	015-082	015-097	015-T01-1P	
35	015-054	015-067	015-083	015-098	015-113	
40	*015-055	015-068	015-084	015-099	015-114	015-137
45	015-056	015-069	015-085	015-100	015-115	015-138
50	015-057	015-070	015-086	015-101	015-116	015-139
55		015-071	015-087	015-102	015-117	015-140
60	015-059	015-072	015-088	015-103	015-118	015-141
65	015-060	015-073	015-089	015-104	015-119	015-142
70	015-061	015-074	015-090	015-105	015-120	015-143
75				015-106	015-121	015-144
80		015-076	015-092	015-107	015-122	015-145
90		015-077	015-093	015-108	015-123	015-146
100		015-078	015-094	015-109	015-124	015-147
110				015-110	015-125	015-148
120				015-111	015-126	
130					015-127	015-150
140					015-128	015-151
150					015-129	015-152
160					015-130	015-153
170				(Zinc Plated)	015-131	015-154
180					015-132	015-155
190					015-133	015-156
200					015-134	015-157
*015-055ZP Zinc Pltd.    015-080ZP Zinc Pltd.    015-071ZP Zinc. Pltd. 015-145ZP Zinc Pltd.    015-098ZP Zinc. Pltd.						

Contact Sales Desk For Package Quantities

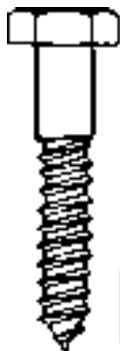

**STEEL**  
**LAG SCREWS**  
 HEXAGON HEAD

For Lag Screws See Page B257

CATALOG 14 SPAENAUR

More Metric Carriage Bolts on following page

Carriage Bolts / Elevator Bolt Assemblies

Ensembles de boulons de carrosserie et de boulons d'ascenseur

Metric

Métrique



B

METRIC

Carriage Bolts

DIN 603

Regular (Coarse)  
METRIC THREAD

ROUND HEAD SQUARE NECK

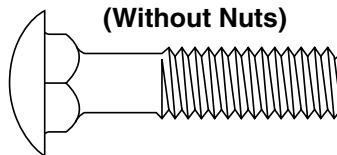

(Without Nuts)  
For Metric Hex Nuts, see pages C9 to C15.

18-8  
STAINLESS  
STEEL

Dia. mm	M6	M8	M10	M12	M16
Pitch mm	1.00	1.25	1.50	1.75	2.00
Lgth. mm	ORDER BY SPAENAUR NUMBERS LISTED BELOW				
25	015-800				
30	015-801	015-807			
40	015-802	015-808	015-813		
50	015-803	015-809	015-814	015-820	015-828
60	015-804	015-810	015-815	015-821	015-829
70	015-805	015-811	015-816	015-822	015-830
80	015-806	015-812	015-817	015-824	015-831
90			015-818	015-824	
100			015-819	015-826	015-832
120				015-827	015-833

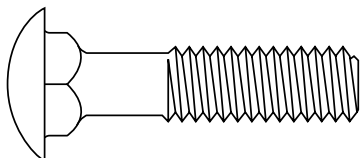

BRASS

Contact Sales Desk For Package Quantities

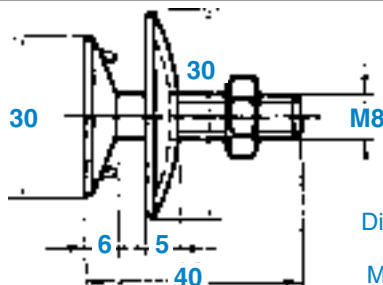

PKG QTY. 50

DIN 15237

SPAENAUR No. 018-100

Metric

Elevator Bolt with Domed Washer and Hex Nut

Property Class 4.6 Steel, Zinc Plated

Regular (COARSE) Metric Thread M8 x 1.25 mm Pitch

See Page B124 for Carriage Bolts

