

Inch

Cap Push Nuts

Pouce

Écrous capuchons

Push-on Fasteners



Style PW

WASHER CAP TYPE

Steel - Zinc Electroplate and Bright Chromate Finish

High quality, heat-treated

One piece cap fasteners for unthreaded rod or stud ends. Provides big savings - better assemblies. Push on or tap with hammer...it's assembled! No threading, notching, or drilling for cotter pins! Used as hubcaps on small wheeled goods, as hinge pin fasteners, machinery rods and pivots, etc.

INCH SIZES

- Easy, speedy assembly.
- Rugged holding power.
- Sturdy construction - will not dent or deform.
- Always assembles in line - will not cock or misalign.
- Push or hammer on.

SPAENAUR No.	*Stud Dia.	Washer Dia.	Cap Dia.	Height	Push-on Force	Min. Holding Strength	PKG QTY.
076-G02-1Y	3/16"(.188)	1/2"	.220"	.202"	30 lbs.	220 lbs.	100
076-G03-1C	1/4"(.250)	9/16"	.289"	.205"	65 lbs.	360 lbs.	100
CRP-47	5/16"(.312)	5/8"	.358"	.236"	90 lbs.	460 lbs.	100
CRP-48	3/8"(.375)	11/16"	.419"	.234"	70 lbs.	380 lbs.	100
076-G04-1N	3/8"(.375)	3/4"	.431"	.270"	90 lbs.	700 lbs.	100
▲076-G05-1T	7/16"(.438)	7/8"	.504"	.328"	150 lbs.	960 lbs.	100
076-G01-1P	1/2"(.500)	15/16"	.567"	.328"	150 lbs.	800 lbs.	100
▲076-002	5/8"(.625)	1-3/16"	.693"	.413"	230 lbs.	1500 lbs.	100

▲Mechanical Zinc Plated

*Recommended diameter tolerance of stud is +.002" and -.003". Surface hardness of stud must not exceed Rockwell 30T-78. Nickel-chrome plating or other hard finishes not recommended on steel studs.



- Caps self-align on shafts
- Low push-on force, high retention
- Fast installation

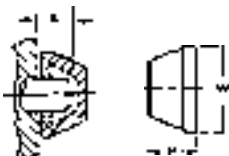

Design 1

Cap Type Push-on Fasteners

BLACK HIGH DENSITY POLYETHYLENE CAPS with SPRING STEEL INSERTS

SPAENAUR No.	Stud, Rod, or Wire Shaft Dia.	DIMENSIONS IN INCHES					Steel Thickness	Max. Tooth Design	PERFORMANCE In Pounds	
		Cap Outside Dia. W	Height O.A. H	Min. Shaft Ext. A	Max. Cap Penetration B	Min. Push-on Force			Holding Strength	
*076-018	3/8	1.300	.645	.200	.525	.018	1	85	1200	
076-020	5/8	1.300	.645	.200	.525	.018	1	90	1200	

* White Plastic Caps

PKG QTY. 100

DECORATIVE HUB CAP FASTENERS

Hammer Style



Spenaaur No. 076-G06-1K

Light Action, for 1/4" Stud, Steel - Nickel Pltd.

5/8" O.D. x 13/64" Height - PKG QTY. 50

Spenaaur No. CRP-5

Light Action, for 3/8" Stud, Steel - Nickel Pltd.

7/8" O.D. x 25/64" Height - PKG QTY. 50

Spenaaur No. CRP-13

Hard Action, for 1/2" Stud, Steel - Nickel Pltd.

7/8" O.D. x 25/64" Height - PKG QTY. 50

Dome Style



Spenaaur No. CRP-26

PKG QTY. 50

Light Action, for 5/16" Stud, Steel - Nickel Pltd.

5/8" O.D. x 5/16" Height