

Hex Socket Cap Screws / Hex Keys / Countr-Bor Screws

Vis à 6 pans creux/Clés hexagonales/Vis de chambrage



Inch and Metric  
Pouce et Métrique

**ASSORTMENT** **805-454A** Inch Sizes

**HEX SOCKET CAP SCREWS**

Alloy Steel, Not Plated  
**22 SIZES - 600 PIECES**

Coarse Thread - 1960 Series  
10-24 to 1/2"-13

(Includes Hex Keys)

Grey Enamelled Drawer 13-3/8" x 9-1/4" x 2"  
fits the Slide Racks shown on page A2.

Shipping Wt: **8.9 kg** (19.75 lbs.)



| Name                 | Spaenaur No. | Thread Size | Bolt Length | Qty. | Page |
|----------------------|--------------|-------------|-------------|------|------|
| Cap Screw Hex Socket | HX-11        | #10-24      | 1/2"        | 50   | B196 |
|                      | HX-12        |             | 3/4"        |      |      |
|                      | HX-13        |             | 1"          |      |      |
|                      | HX-41        | 1/4"-20     | 1-1/4"      | 40   |      |
|                      | HX-42        |             | 1-1/2"      |      |      |
|                      | HX-16        |             | 1"          |      |      |
|                      | 363-A22-1N   | 5/16"-18    | 3/4"        | 35   |      |
|                      | HX-17        |             | 1-1/4"      |      |      |
|                      | HX-18        |             | 1-1/2"      |      |      |
|                      | HX-19        | 3/8" -16    | 3/4"        | 30   |      |
|                      | HX-20        |             | 1"          |      |      |
|                      | HX-34        |             | 1-1/4"      |      |      |
|                      | HX-21        | 7/16"-14    | 1-1/2"      | 25   |      |
|                      | HX-30        |             | 3/4"        |      |      |
|                      | HX-22        |             | 1"          |      |      |
|                      | 363-A01-1W   | 1/2"-13     | 1-1/4"      | 15   |      |
|                      | HX-249       |             | 3/4"        |      |      |
|                      | HX-276       |             | 1"          |      |      |
| HX-277               | 1/2"-13      | 1-1/2"      | 10          |      |      |
| HX-126               |              | 3/4"        |             |      |      |
| HX-127               |              | 1"          |             |      |      |
| HX-25                | 1-1/2"       | 15          |             |      |      |
| Hex Key              | SS-66K       | 5/32"       | 5           | P7   |      |
|                      | SS-67K       | 3/16"       | 3           |      |      |
|                      | SS-68K       | 1/4"        | 3           |      |      |
|                      | SS-69K       | 5/16"       | 2           |      |      |
|                      | SS-104K      | 3/8"        | 2           |      |      |

**ASSORTMENT** **805-652**

12 point Flanged Head  
**ALLOY STEEL**

**COUNTR-BOR SCREWS**

Coarse and Fine Thread

**24 Sizes**  
**455 Pieces**



Furnished in Large Size grey enamelled steel drawer with hinged lid and catch. Drawer will fit into Slide Racks shown on page A3

Shipping Weight:  
**13.33 kg**  
(29.4 lbs.)

| Thread Type | Spaenaur No. | Thread Size | Length | Qty. | Page |
|-------------|--------------|-------------|--------|------|------|
| Coarse      | CS-153       | 1/4"-20     | 3/4"   | 30   | B210 |
|             | CS-154       |             | 7/8"   |      |      |
|             | CS-155       |             | 1"     |      |      |
|             | CS-168       | 5/16"-18    | 1-1/2" | 25   |      |
|             | CS-170       |             | 2"     |      |      |
|             | CS-172       |             | 1"     |      |      |
|             | CS-182       | 3/8"-16     | 1-1/4" | 20   |      |
|             | CS-183       |             | 1-1/2" |      |      |
|             | CS-184       |             | 1-1/4" |      |      |
|             | CS-200       | 7/16"-14    | 1-1/4" | 15   |      |
|             | CS-203       |             | 2"     |      |      |
|             | CS-205       |             | 2-1/2" |      |      |
|             | CS-212       | 1/2"-13     | 3/4"   | 10   |      |
|             | CS-215       |             | 1-1/4" |      |      |
|             | CS-216       |             | 1-1/2" |      |      |
| CS-218      | 1/4"-28      | 2"          | 30     |      |      |
| CS-304      |              | 7/8"        |        |      |      |
| CS-309      |              | 1-1/4"      |        |      |      |
| CS-311      | 5/16"-24     | 1-1/4"      | 25     |      |      |
| CS-312      |              | 1-1/2"      |        |      |      |
| CS-321      |              | 1"          |        |      |      |
| CS-329      | 7/16"-20     | 1-1/4"      | 15     |      |      |
| CS-334      |              | 1-1/2"      |        |      |      |
| CS-338      |              | 2-1/2"      |        |      |      |

**ASSORTMENT** **805-498**

Regular (Coarse) Thread  
**FULL Cylinder Head**

**METRIC Hex Socket Cap Screws**

Property Class 8.8 Med. Carbon Steel Not Plated

**DIN 912**

**24 Sizes**  
**500 Pieces**



Put up in REGULAR SIZE grey enamelled STEEL drawer. Drawer will fit the Slide Racks on page A2.

Shipping Weight:  
**5.53 kg**  
(12.2 lbs.)

| Name                                 | Spaenaur No. | Size       | Qty. | Page |
|--------------------------------------|--------------|------------|------|------|
| Fully Threaded Hex Socket Cap Screws | 367-B04-1P   | M3 x 10mm  | 30   | B212 |
|                                      | 367-012      | M3 x 16mm  |      |      |
|                                      | 367-019      | M4 x 12mm  |      |      |
|                                      | 367-021      | M4 x 20mm  | 25   |      |
|                                      | 367-034      | M5 x 8mm   |      |      |
|                                      | 367-B05-1Y   | M5 x 12mm  |      |      |
|                                      | 367-038      | M5 x 20mm  | 20   |      |
|                                      | 367-039      | M5 x 25mm  |      |      |
|                                      | 367-055      | M6 x 10mm  |      |      |
|                                      | 367-B07-1N   | M6 x 16mm  | 15   |      |
|                                      | 367-059      | M6 x 25mm  |      |      |
|                                      | 367-075      | M8 x 12mm  |      |      |
|                                      | 367-077      | M8 x 20mm  | 10   |      |
|                                      | 367-079      | M8 x 30mm  |      |      |
|                                      | 367-100      | M10 x 16mm |      |      |
|                                      | 367-102      | M10 x 25mm | 30   |      |
|                                      | 367-132      | M12 x 30mm |      |      |
|                                      | 367-134      | M12 x 40mm |      |      |
| 367-014                              | M3 x 25mm    | 25         |      |      |
| 367-023                              | M4 x 30mm    |            |      |      |
| 367-025                              | M4 x 40mm    |            |      |      |
| 367-040                              | M5 x 30mm    | 20         |      |      |
| 367-061                              | M6 x 35mm    |            |      |      |
| 367-081                              | M8 x 40mm    |            |      |      |

Metric

Métrique



Hex Socket Cap Screws / Hex Keys

Vis à 6 pans creux/Clés hexagonales

**ASSORTMENT** **805-435** **DIN 7984**  
**ASSORTIMENT**

**METRIC Hex Socket Cap Screws**

**LOW Cylinder Head Style**

Regular COARSE Metric Thread

Med. Carbon Steel, Metric

**Property Class 8.8** Not Plated

**Total Contents: 28 Sizes - 585 Pieces**

REGULAR SIZE welded STEEL drawer with Hinged Lid & Scooped Bins. Drawer fits the Slide Racks shown on Page A2

Shipping Weight: **9.41 kg** (20-3/4 lbs.)

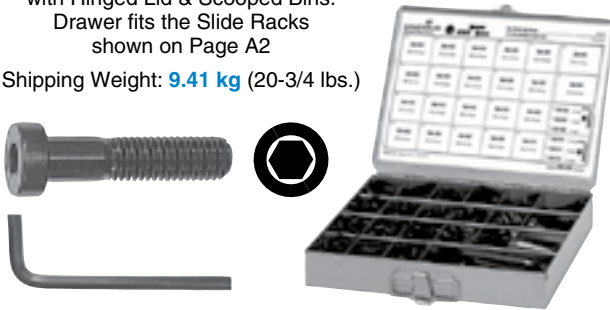

| Name       | Thread Size | Spaenaur No. | Bolt Length | Qty. | Page |
|------------|-------------|--------------|-------------|------|------|
| Cap Screws | M5 x 0.80   | 366-403      | 16mm        | 50   | B217 |
|            |             | 366-405      | 20mm        |      |      |
|            |             | 366-407      | 25mm        |      |      |
|            | M6 x 1.00   | 366-409      | 12mm        | 40   |      |
|            |             | 366-411      | 16mm        |      |      |
|            |             | 366-413      | 20mm        |      |      |
|            |             | 366-415      | 25mm        |      |      |
|            | M8 x 1.25   | 366-416      | 30mm        |      |      |
|            |             | 366-418      | 16mm        | 30   |      |
|            |             | 366-420      | 20mm        |      |      |
|            | M10 x 1.50  | 366-422      | 25mm        | 25   |      |
|            |             | 366-423      | 30mm        |      |      |
|            |             | 366-426      | 20mm        | 20   |      |
|            | M12 x 1.75  | 366-428      | 25mm        | 15   |      |
|            |             | 366-429      | 30mm        |      |      |
|            |             | 366-431      | 40mm        |      |      |
| M16 x 2.00 | 366-433     | 25mm         | 10          |      |      |
|            | 366-434     | 30mm         |             |      |      |
|            | 366-435     | 35mm         |             |      |      |
|            | 366-440     | 40mm         | 5           |      |      |
|            | 366-442     | 50mm         |             |      |      |
|            | 366-444     | 60mm         |             |      |      |
| Name       | Key Size    | Spaenaur No. | Qty.        | Page |      |
| Hex Keys   | 3mm         | 130-206      | 3           | P9   |      |
|            | 4mm         | 130-207      |             |      |      |
|            | 5mm         | 130-208      |             |      |      |
|            | 7mm         | 130-210      |             |      |      |
|            | 8mm         | 130-211      |             |      |      |
|            | 12mm        | 130-214      |             |      |      |

**ASSORTMENT** **805-500** **DIN 912**  
**ASSORTIMENT**

**METRIC**

**Hex Socket Cap Screws**

**Property Class 12.9**

**Alloy Steel Not Plated**

Contains Full and Partial Metric Regular Coarse Threads

**24 Sizes — 500 Pieces**

Put up in Grey Enamelled Steel Drawer. Drawer will fit into Slide Racks shown on page A2

Shipping Weight: **5.44 kg** (12 lbs.)



| Thread Type    | Spaenaur No. | Thread Size | Bolt Length | Qty. | Page |
|----------------|--------------|-------------|-------------|------|------|
| Partial Thread | 366-711      | M3 x 0.50   | 25mm        | 30   | B223 |
|                | 366-720      | M4 x 0.70   | 30mm        | 25   |      |
|                | 366-722      |             | 40mm        | 30   |      |
|                | 366-731      | M5 x 0.80   | 30mm        | 25   |      |
|                | 366-743      | M6 x 1.00   | 35mm        | 20   |      |
|                | 366-759      | M8 x 1.25   | 40mm        | 15   |      |
| Full Thread    | 366-707      | M3 x 0.50   | 10mm        | 30   | B221 |
|                | 366-709      |             | 16mm        |      |      |
|                | 366-716      | M4 x 0.70   | 12mm        |      |      |
|                | 366-718      |             | 20mm        |      |      |
|                | 366-725      | M5 x 0.80   | 8mm         | 25   |      |
|                | 366-727      |             | 12mm        |      |      |
|                | 366-729      |             | 20mm        |      |      |
|                | 366-730      |             | 25mm        |      |      |
|                | 366-737      | M6 x 1.00   | 10mm        | 20   |      |
|                | 366-739      |             | 16mm        |      |      |
|                | 366-741      | M8 x 1.25   | 25mm        | 15   |      |
|                | 366-753      |             | 12mm        |      |      |
|                | 366-755      |             | 20mm        |      |      |
|                | 366-757      | M10 x 1.50  | 30mm        | 10   |      |
|                | 366-771      |             | 16mm        |      |      |
|                | 366-773      | 25mm        |             |      |      |
|                | 366-794      | M12 x 1.75  | 20mm        |      |      |
|                | 366-798      |             | 40mm        |      |      |

A

# Hex Socket Cap Screws / Button Head Hex Socket Cap Screws

Vis à 6 pans creux / vis à 6 pans creux de type bouton



Metric  
Métrique

**ASSORTMENT**  
**ASSORTIMENT** **805-467**

## METRIC HEX SOCKET CAP SCREWS A2 Stainless Steel

(with Alloy Steel Keys)

Metric, Type **DIN 912**

27 KINDS - 580 PIECES (incl. Keys)

REGULAR SIZE grey enamelled steel drawer will fit Slide Racks shown page A2.

Shipping weight: **9.3 kg** (20.5 lbs.)



**ASSORTMENT**  
**ASSORTIMENT** **805-477**

## METRIC BUTTON HEAD Hex Socket Cap Screws

Property Class 10.9 Steel  
Not Plated

24 Sizes - 720 Pieces **ISO 7380**

Regular Coarse Thread

REGULAR SIZE grey enamelled steel drawer will fit Slide Racks shown page A2.

Shipping weight: **6.8 kg** (15 lbs.)



| Name                 | Thread Size | Compatible Key Size | Spaenaur No. | Bolt Length | Qty. | Page |
|----------------------|-------------|---------------------|--------------|-------------|------|------|
| Cap Screw Hex Socket | M5 x 0.80   | 4mm                 | 373-017      | 16mm        | 50   | B227 |
|                      |             |                     | 373-B12-1W   | 20mm        |      |      |
|                      |             |                     | 373-019      | 25mm        | 40   |      |
|                      |             |                     | 373-020      | 30mm        |      |      |
|                      | M6 x 1.00   | 5mm                 | 373-B24-1W   | 35mm        | 35   |      |
|                      |             |                     | 373-028      | 20mm        |      |      |
|                      |             |                     | 373-029      | 25mm        |      |      |
|                      |             |                     | 373-030      | 30mm        |      |      |
|                      | M8 x 1.25   | 6mm                 | 373-031      | 35mm        | 30   |      |
|                      |             |                     | 373-038      | 16mm        |      |      |
|                      |             |                     | 373-039      | 20mm        | 25   |      |
|                      |             |                     | 373-040      | 25mm        |      |      |
|                      | M10 x 1.50  | 8mm                 | 373-041      | 30mm        | 15   |      |
|                      |             |                     | 373-042      | 35mm        |      |      |
|                      |             |                     | 373-053      | 20mm        |      |      |
|                      |             |                     | 373-054      | 25mm        |      |      |
| M12 x 1.75           | 10mm        | 373-055             | 30mm         | 10          |      |      |
|                      |             | 373-067             | 25mm         |             |      |      |
|                      |             | 373-068             | 30mm         |             |      |      |
|                      |             | 373-069             | 35mm         |             |      |      |
|                      |             | 373-070             | 40mm         |             |      |      |
|                      |             | 373-072             | 50mm         |             |      |      |
| Name                 |             |                     | Spaenaur No. | Key Size    | Qty. | Page |
| Hex Key              |             |                     | 130-207      | 4mm         | 5    | P9   |
|                      |             |                     | 130-208      | 5mm         | 3    |      |
|                      |             |                     | 130-209      | 6mm         |      |      |
|                      |             |                     | 130-211      | 8mm         | 2    |      |
|                      |             |                     | 130-213      | 10mm        |      |      |

| Product Type                     | Thread Size | Spaenaur No. | Length Under Head | Qty. | Page |    |
|----------------------------------|-------------|--------------|-------------------|------|------|----|
| Cap Screw Hex Socket Button Head | M5 x 0.80   | 366-600      | 10mm              | 50   | B229 |    |
|                                  |             | 366-603      | 16mm              |      |      |    |
|                                  |             | 366-605      | 20mm              |      |      |    |
|                                  |             | 366-606      | 25mm              |      |      |    |
|                                  |             | 366-607      | 30mm              |      |      |    |
|                                  | M6 x 1.00   | 366-613      | 12mm              | 40   |      |    |
|                                  |             | 366-615      | 16mm              |      |      |    |
|                                  |             | 366-W02-1T   | 20mm              |      |      |    |
|                                  |             | 366-618      | 25mm              |      |      |    |
|                                  |             | 366-619      | 30mm              |      |      |    |
|                                  | M8 x 1.25   | 366-620      | 35mm              | 35   |      |    |
|                                  |             | 366-621      | 40mm              |      |      |    |
|                                  |             | 366-624      | 10mm              |      |      | 30 |
|                                  |             | 366-626      | 14mm              |      |      |    |
|                                  |             | 366-627      | 16mm              |      |      |    |
|                                  | M10 x 1.50  | 366-629      | 20mm              | 25   |      |    |
|                                  |             | 366-630      | 25mm              |      |      |    |
|                                  |             | 366-631      | 30mm              |      |      | 20 |
|                                  |             | 366-633      | 40mm              |      |      |    |
|                                  |             | 366-634      | 45mm              |      |      |    |
|                                  | M10 x 1.50  | 366-636      | 16mm              | 15   |      |    |
|                                  |             | 366-639      | 25mm              |      |      |    |
|                                  |             | 366-641      | 35mm              |      |      | 10 |
|                                  |             | 366-644      | 50mm              |      |      |    |

Inch and **Metric**

Pouce et **Métrique**



**Shoulder Screws / Flat Head Cap Screws / Set Screws**

Vis à épaulement / Vis à tête plate / Vis de pression

**ASSORTMENT 805-489**  
ASSORTIMENT

**Metric DIN 7379**

**Hex Socket Shoulder Screws**

**Property Class 12.9**  
**Alloy Steel - Plain Finish**  
**Metric Regular**  
**(Coarse) Thread**

**24 Sizes — 107 Pieces**

Furnished in Regular Size grey enamelled steel drawer with hinged lid and catch.  
Drawer will fit into Slide Racks shown on page A2.

Shipping Weight: **4.19 kg** (9-1/4 lbs.)



| Thread Size  | Thread Length | Shoulder Diameter | Spenaaur No. | Shoulder Length | Qty. | Page |
|--------------|---------------|-------------------|--------------|-----------------|------|------|
| M5 x 0.80mm  | 9.5mm         | 6mm               | 365-001      | 10mm            | 5    | B233 |
|              |               |                   | 365-002      | 12mm            |      |      |
|              |               |                   | 365-003      | 16mm            |      |      |
|              |               |                   | 365-004      | 20mm            |      |      |
|              |               |                   | 365-005      | 25mm            |      |      |
|              |               |                   | 365-006      | 30mm            |      |      |
| M6 x 1.00mm  | 11.0mm        | 8mm               | 365-007      | 40mm            |      |      |
|              |               |                   | 365-009      | 12mm            |      |      |
|              |               |                   | 365-010      | 16mm            |      |      |
|              |               |                   | 365-012      | 25mm            |      |      |
|              |               |                   | 365-011      | 20mm            |      |      |
|              |               |                   | 365-013      | 30mm            |      |      |
| M8 x 1.25mm  | 13.0mm        | 10mm              | 365-014      | 40mm            |      |      |
|              |               |                   | 365-017      | 16mm            |      |      |
|              |               |                   | 365-018      | 20mm            |      |      |
|              |               |                   | 365-019      | 25mm            |      |      |
|              |               |                   | 365-020      | 30mm            |      |      |
|              |               |                   | 365-021      | 40mm            |      |      |
| M10 x 1.50mm | 16.0mm        | 12mm              | 365-022      | 50mm            | 3    |      |
|              |               |                   | 365-026      | 16mm            |      |      |
|              |               |                   | 365-027      | 20mm            |      |      |
|              |               |                   | 365-028      | 25mm            |      |      |
|              |               |                   | 365-029      | 30mm            |      |      |
|              |               |                   | 365-P02-1P   | 40mm            |      | 2    |

**A**

**ASSORTMENT 805-538**  
ASSORTIMENT

**DIN 7991**

**Hex Socket Flat Head Cap Screws**  
**Property Class 10.9**

**Fully Threaded Metric Coarse Thread**  
**Countersunk Flat Head**

Furnished in Regular Size grey enamel steel drawer with hinged drawer with hinged lid and catch.

Drawer will fit into Slide Racks shown on page A2.

**22 Sizes**  
**545 Pieces**

Not Plated

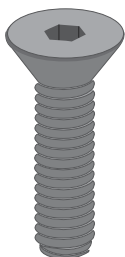

| Spenaaur No. | Thread Size | Bolt Length | Qty. | Page |
|--------------|-------------|-------------|------|------|
| 366-566      | M3 x 0.50   | 10mm        | 50   | B230 |
| 366-568      |             | 16mm        |      |      |
| 366-571      |             | 25mm        |      |      |
| 366-574      | M4 x 0.70   | 12mm        | 25   |      |
| 366-577      |             | 20mm        |      |      |
| 366-579      |             | 30mm        |      |      |
| 366-581      |             | 40mm        |      |      |
| 366-583      | M5 x 0.80   | 8mm         | 20   |      |
| 366-501      |             | 12mm        |      |      |
| 366-505      |             | 20mm        |      |      |
| 366-506      |             | 25mm        |      |      |
| 366-507      |             | 30mm        |      |      |
| 366-509      | M6 x 1.00   | 10mm        | 25   |      |
| 366-512      |             | 16mm        |      |      |
| 366-515      |             | 25mm        |      |      |
| 366-517      |             | 35mm        |      |      |
| 366-519      | M8 x 1.25   | 16mm        | 20   |      |
| 366-520      |             | 18mm        |      |      |
| 366-521      |             | 20mm        |      |      |
| 366-523      |             | 30mm        |      |      |
| 366-526      | M10 x 1.50  | 16mm        | 15   |      |
| 366-529      |             | 25mm        |      |      |

**ASSORTMENT B-583**  
ASSORTIMENT

**CUP POINT**

**Hex Socket Set Screws**  
**21 SIZES - 940 PIECES**



Regular Size welded Steel Drawer has hinged lid and is finished in grey enamel.

Will fit into the Slide Racks, shown on page A2.

Shipping Weight: **2.95 kg** (7 lbs.)

| Name                 | Spenaaur No. | Thread Size  | Screw Length | Qty. | Page |      |
|----------------------|--------------|--------------|--------------|------|------|------|
| Hex Socket Set Screw | SS-34        | #6-32        | 3/16"        | 100  | B234 |      |
|                      | SS-35        |              | 1/4"         |      |      |      |
|                      | SS-40        |              | 3/8"         |      |      |      |
|                      | SS-42        | #8-32        | 3/8"         | 75   |      |      |
|                      | SS-43        |              | 3/16"        |      |      |      |
|                      | SS-45        | #10-24       | 5/16"        | 100  |      |      |
|                      | SS-48        |              | 1/4"         |      |      |      |
|                      | SS-50        | #10-32       | 1/4"         | 50   |      |      |
|                      | SS-51        |              | 3/8"         |      |      |      |
|                      | SS-53        | 5/16"-18     | 5/16"        | 40   |      |      |
|                      | SS-54        |              | 3/8"         |      |      |      |
|                      | SS-56        | 3/8"-16      | 3/8"         | 35   |      |      |
|                      | 478-E10-1M   |              | 30           |      |      |      |
|                      | SS-58        | 1/2"-13      | 1/2"         | 25   |      | B235 |
|                      | Name         | Spenaaur No. | Key Size     |      |      | Qty. |
| Hex Key              | SS-62K       | 1/16"        |              | 6    | P7   |      |
|                      | SS-63K       | 5/64"        |              |      |      |      |
|                      | SS-64K       | 3/32"        |              |      |      |      |
|                      | SS-65K       | 1/8"         |              | 4    | P7   |      |
|                      | SS-66K       | 5/32"        |              |      |      |      |
|                      | SS-67K       | 3/16"        |              |      |      |      |
| SS-68K               | 1/4"         |              | 3            |      |      |      |

CATALOG 14 SPAENAUR

Spenaaur reserves the right to substitute parts in any assortment without notice. For any questions or suggestions about our Assortments and Plastikits, please contact us 1-800-265-8772. © 2018 Spenaaur Inc. All rights reserved. Catalog may not be reproduced, in whole or in part, without the written permission of Spenaaur Inc. Subject to Catalog Terms and Conditions of Use available at Spenaaur.com and on page TC2 and TC3 at the back of this catalog. Spenaaur se réserve le droit de remplacer des pièces dans n'importe quel assortiment sans préavis. Pour toute question ou suggestion concernant nos Assortiments et Plastikits, veuillez nous contacter au 1-800-265-8772. © 2018 Spenaaur Inc. Tous droits réservés. Le catalogue ne peut être reproduit, en tout ou en partie, sans l'autorisation écrite de Spenaaur Inc. L'utilisation est soumise aux Conditions d'utilisation du Catalogue disponibles sur Spenaaur.com et à la page TC4 et TC5 à la fin de ce catalogue.

**A55**

# Hex Socket Set Screws / Hex Keys

Vis de pression à tête creuse hexagonale / Clés hexagonales



Inch

Pouce

**PLASTIKIT**  
«PLASTIKIT» **804-085**

CUP POINT

## HEX SOCKET SET SCREWS



**ALLOY STEEL - NOT PLATED**  
**20 Sizes, 155 Pieces**

Put up in a clear, durable plastic container with hinged lid. Size: 1" x 2-3/4" x 4-1/2"

| Name                 | Spaenaur No. | Thread Size  | Screw Length | Qty. | Page |
|----------------------|--------------|--------------|--------------|------|------|
| Set Screw Hex Socket | SS-28        | #4-40        | 1/8"         | 10   | B234 |
|                      | SS-35        | #6-32        | 1/4"         |      |      |
|                      | SS-39        | #8-32        | 3/16"        |      |      |
|                      | SS-40        |              | 1/4"         |      |      |
|                      | SS-42        |              | 3/8"         |      |      |
|                      | SS-85        |              | 1/2"         |      |      |
|                      | SS-43        | #10-24       | 3/16"        |      |      |
|                      | SS-47        | #10-32       | 1/4"         |      |      |
|                      | SS-48        |              | 3/8"         |      |      |
|                      | SS-181       |              | 1/4"         |      |      |
|                      | SS-50        |              | 5/16"        |      |      |
|                      | SS-189       | 1/4"-20      | 3/8"         |      |      |
|                      | SS-51        |              | 1/2"         |      |      |
|                      | SS-52        |              | 1"           |      |      |
|                      | SS-86        |              | 1"           |      |      |
|                      | Name         | Spaenaur No. | Key Size     |      |      |
| Hex Key              | SS-61K       | 0.050"       |              | 1    | P7   |
|                      | SS-62K       | 1/16"        |              |      |      |
|                      | SS-63K       | 5/64"        |              |      |      |
|                      | SS-64K       | 3/32"        |              |      |      |
|                      | SS-65K       | 1/8"         |              |      |      |

**ASSORTMENT**  
**ASSORTIMENT** **805-517**

Cup Point

## Hex Socket Set Screws

### 18-8 Stainless Steel



**940 Pieces, 21 Sizes**

Furnished in a grey enamelled REGULAR SIZE steel drawer  
Will fit slide racks shown on page A2.

Shipping Weight: **2.94 kg** (6-1/2 lbs.)

| Name                 | Spaenaur No. | Thread Size  | Screw Length | Qty. | Page      |      |
|----------------------|--------------|--------------|--------------|------|-----------|------|
| Hex Socket Set Screw | 479-D07-1P   | #6-32        | 3/16"        | 100  | B238      |      |
|                      | SS-2001      |              | 1/4"         | 60   |           |      |
|                      | SS-2023      | #8-32        | 3/8"         | 75   |           |      |
|                      | SS-2024      |              | 3/16"        | 100  |           |      |
|                      | 479-D16-1M   | #10-24       | 1/4"         | 50   |           |      |
|                      | SS-2028      |              | 3/8"         | 40   |           |      |
|                      | 479-D33-1P   | #10-32       | 5/16"        | 35   |           |      |
|                      | 479-D34-1Y   |              | 1/4"-20      | 30   |           |      |
|                      | 479-D29-1X   | 5/16"-18     | 3/8"         | 25   |           |      |
|                      | 479-D25-1T   |              | 5/16"        | 40   |           |      |
|                      | 479-D21-1P   | 3/8"-16      | 1/2"         | 35   |           |      |
|                      | 479-D30-1M   |              | 1/2"-13      | 25   |           |      |
|                      | SS-2052      |              |              |      |           |      |
|                      | SS-2056      |              |              |      |           |      |
|                      | Name         | Spaenaur No. | Key Size     |      |           | Qty. |
| Hex Key              | SS-62K       | 1/16"        |              | 6    | P7        |      |
|                      | SS-63K       | 5/64"        |              |      |           |      |
|                      | SS-64K       | 3/32"        |              |      |           |      |
|                      | SS-65K       | 1/8"         |              | 4    | B75<br>P7 |      |
|                      | SS-66K       | 5/32"        |              | 4    | P7        |      |
|                      | SS-67K       | 3/16"        |              |      |           |      |
|                      | SS-68K       | 1/4"         |              | 3    |           |      |

**ASSORTMENT**  
**ASSORTIMENT** **805-488**

## ALLOY STEEL - NOT PLATED - INCH SIZES

### HEX SOCKET SET SCREWS

**24 SIZES - 500 PIECES**

Put up in a REGULAR SIZE grey enamelled STEEL drawer, which fits slide racks shown on page A2.

Shipping Weight **2.49 kg** (5.5 lbs.)

**"Half-Dog" Point**

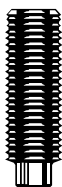

| Name                                     | Thread Size | Spaenaur No. | Screw Length | Qty. | Page |
|--|-------------|--------------|--------------|------|------|
| Set Screw Hex Socket With Half Dog Point | #4-40       | 478-100      | 1/4"         | 40   | B243 |
|  |             | 478-102      | 3/8"         |      |      |
|  | #6-32       | 478-105      | 3/16"        | 30   |      |
|  |             | 478-107      | 5/16"        |      |      |
|  |             | 478-109      | 1/2"         |      |      |
|  | #8-32       | 478-112      | 1/4"         | 20   |      |
|  |             | 478-114      | 3/8"         |      |      |
|  |             | 478-116      | 5/8"         |      |      |
|  | #10-24      | 478-117      | 3/16"        | 15   |      |
|  |             | 478-119      | 5/16"        |      |      |
|  |             | 478-121      | 1/2"         |      |      |
|  | #10-32      | 478-122      | 1/4"         | 10   |      |
|  |             | 478-124      | 3/8"         |      |      |
|  |             | 478-126      | 5/8"         |      |      |
|  | 1/4"-20     | 478-128      | 1"           | 5    |      |
|  |             | 478-130      | 5/16"        |      |      |
|  |             | 478-132      | 1/4"         |      |      |
|  | 1/4"-28     | 478-134      | 3/8"         | 10   |      |
|  |             | 478-136      | 5/8"         |      |      |
|  |             | 478-138      | 1"           |      |      |
|  | 5/16"-18    | 478-140      | 3/8"         | 5    |      |
|  |             | 478-143      | 1/2"         |      |      |
|  | 5/16"-24    | 478-145      | 3/4"         |      |      |
|  |             | 3/8"-16      |              |      |      |

Inch and Metric

Pouce et Métrique



Set Screws / Hex Keys

Vis de pression / Clés hexagonales

ASSORTMENT **B-582**  
ASSORTIMENT

**SQUARE HEAD  
SET SCREWS**  
*CUP POINT / UNC*

**STEEL - Case Hardened - Not Plated**

**18 Varieties - 491 pieces.**

Furnished in Regular Size Steel drawer which will fit into Slide Racks shown on page A2.

Shipping Weight:  
**7.37 kg** (16-1/4 lbs.)



| Thread Size | Spaenaur No. | Screw Length | Qty. | Page |
|-------------|--------------|--------------|------|------|
| 1/4"-20     | SS-2         | 1/2"         | 75   | B244 |
|             | SS-3         | 3/4"         | 50   |      |
|             | SS-4         | 1"           | 35   |      |
|             | SS-6         | 1-1/2"       | 20   |      |
| 5/16"-18    | SS-7         | 1/2"         | 45   |      |
|             | SS-8         | 3/4"         | 30   |      |
|             | SS-9         | 1"           | 25   |      |
| 3/8"-16     | SS-11        | 1-1/2"       | 20   |      |
|             | SS-12        | 1/2"         | 30   |      |
|             | SS-13        | 3/4"         | 25   |      |
|             | SS-14        | 1"           | 30   |      |
| 7/16"-14    | SS-16        | 1-1/2"       | 20   |      |
|             | SS-18        | 3/4"         | 25   |      |
|             | SS-19        | 1"           | 20   |      |
| 1/2"-13     | SS-21        | 1-1/2"       | 10   |      |
|             | SS-23        | 3/4"         | 10   |      |
|             | SS-24        | 1"           | 15   |      |
|             | SS-27        | 2"           | 6    |      |

ASSORTMENT **805-468** **DIN 916** ~ ISO 4029 **DIN 911**  
ASSORTIMENT

**METRIC Hex Socket Set Screws**  
Regular Coarse Thread *CUP POINT*

**304 STAINLESS STEEL**  
**24 Sizes - 410 Pieces**

REGULAR SIZE welded steel drawer with hinged lid and scooped bins, finished in grey enamel. Fits the Slide Racks shown on page A2

Shipping Weight: **2.49 kg** (5.5 lbs.)



| Name  | Thread Size                        | Screw Length | Spaenaur No. | Qty.    | Page |   |    |
|---|------------------------------------|--------------|--------------|---------|------|---|----|
| Set Screw Hex Socket Cup Point 304 Stainless Steel DIN 916 Metric | M4 x 0.70                          | 6mm          | 482-004      | 30      | B249 |   |    |
|   |                                    | 8mm          | 482-005      |         |      |   |    |
|   |                                    | 10mm         | 482-006      |         |      |   |    |
|   |                                    | 12mm         | 482-007      |         |      |   |    |
|   |                                    | 16mm         | 482-008      |         |      |   |    |
|   |                                    | 8mm          | 482-010      |         |      |   |    |
|   | M5 x 0.80                          | 10mm         | 482-W05-1W   | 25      |      |   |    |
|   |                                    | 12mm         | 482-012      |         |      |   |    |
|   |                                    | 16mm         | 482-013      |         |      |   |    |
|   |                                    | 20mm         | 482-014      |         |      |   |    |
|   | M6 x 1.00                          | 8mm          | 482-016      | 20      |      |   |    |
|   |                                    | 10mm         | 482-017      |         |      |   |    |
|   |                                    | 12mm         | 482-018      |         |      |   |    |
|   |                                    | 16mm         | 482-W04-1K   |         |      |   |    |
|   |                                    | 20mm         | 482-020      |         |      |   |    |
|   | M8 x 1.25                          | 8mm          | 482-054      | 15      |      |   |    |
|   |                                    | 10mm         | 482-055      |         |      |   |    |
|   |                                    | 12mm         | 482-022      |         |      |   |    |
|   |                                    | 16mm         | 482-023      |         |      |   |    |
|   |                                    | 20mm         | 482-024      |         |      |   |    |
|   |                                    |              |              |         |      |   |    |
|   | Hex Key Alloy Steel DIN 911 Metric | Key Size     | 2.0mm        | 130-204 |      | 3 | P9 |
|   |                                    |              | 2.5mm        | 130-205 |      | 2 |    |
|   |                                    |              | 3.0mm        | 130-206 |      | 3 |    |
| 4.0mm   |                                    |              | 130-207      | 2       |      |   |    |

ASSORTMENT **805-405** **DIN 916** ~ ISO 4029  
ASSORTIMENT

**METRIC Hex Socket Set Screws**  
*Metric Coarse Thread CUP POINT*  
**ALLOY STEEL - Not Plated**

**Total Contents - 464 Pieces - 27 Sizes**

REGULAR SIZE welded steel drawer with hinged lid and scooped bins, finished in grey enamel. Fits the Slide Racks shown on page A2.

Shipping Weight: **3.06 kg** (6-3/4 lbs.)

| Name                 | Spaenaur No. | Thread Size  | Screw Length | Qty.  | Page |   |    |
|----------------------|--------------|--------------|--------------|-------|------|---|----|
| Set Screw Hex Socket | 481-013      | M3 x 0.50    | 5mm          | 30    | B248 |   |    |
|                      | 481-015      |              | 8mm          |       |      |   |    |
|                      | 481-020      | 5mm          |              |       |      |   |    |
|                      | 481-C06-1X   | 6mm          |              |       |      |   |    |
|                      | 481-023      | 10mm         |              |       |      |   |    |
|                      | 481-024      | 12mm         |              |       |      |   |    |
|                      | 481-029      | 6mm          |              |       |      |   |    |
|                      | 481-031      | 10mm         |              |       |      |   |    |
|                      | 481-032      | 12mm         |              |       |      |   |    |
|                      | 481-034      | 16mm         |              |       |      |   |    |
|                      | 481-039      | 8mm          |              |       |      |   |    |
|                      | 481-041      | 12mm         |              |       |      |   |    |
|                      | 481-044      | 20mm         |              |       |      |   |    |
|                      | 481-048      | 8mm          |              |       |      |   |    |
|                      | 481-050      | 12mm         |              |       |      |   |    |
|                      | 481-053      | 25mm         |              |       |      |   |    |
|                      | 481-056      | 10mm         |              |       |      |   |    |
|                      | 481-081      | 16mm         |              |       |      |   |    |
|                      | 481-058      | 20mm         |              |       |      |   |    |
|                      | 481-062      | 16mm         |              |       |      |   |    |
|                      | Hex Key      | Spaenaur No. | Key Size     | 1.5mm |      | 5 | P9 |
|                      |              |              |              | 2.0mm |      |   |    |
|                      |              |              |              | 2.5mm |      |   |    |
|                      |              |              |              | 3.0mm |      |   |    |
|                      |              |              |              | 4.0mm |      |   |    |
|                      |              |              |              | 5.0mm |      |   |    |
|                      |              |              |              | 6.0mm |      | 3 |    |

Set Screws / Hex Keys

Vis de pression / Clés hexagonales



Metric  
Métrique

A

**PLASTIKIT**  
«PLASTIKIT» **804-086**

**METRIC**

**Hex Socket Set Screws with Keys**

**DIN 916**

**45H STEEL , Not Plated**  
**20 Sizes - 155 Pieces**



Size: 1" x 2-3/4" x 4-1/2"  
Clear durable, plastic container



| Name  | Spaenaur No. | Thread Size | Screw Length | Qty. | Page |
|---|--------------|-------------|--------------|------|------|
| Set Screw Hex Socket 45H Steel Cup Point DIN 916 Metric | 481-011      | M3 x 0.50   | 3mm          | 10   | B248 |
|   | 481-013      |             | 5mm          |      |      |
|   | 481-014      |             | 6mm          |      |      |
|   | 481-019      | M4 x 0.70   | 4mm          |      |      |
|   | 481-020      |             | 5mm          |      |      |
|   | 481-C06-1X   |             | 6mm          |      |      |
|   | 481-024      | M5 x 0.80   | 12mm         |      |      |
|   | 481-028      |             | 5mm          |      |      |
|   | 481-029      |             | 6mm          |      |      |
|   | 481-038      | M6 x 1.00   | 8mm          |      |      |
|   | 481-039      |             | 10mm         |      |      |
|   | 481-040      |             | 12mm         |      |      |
|   | 481-041      | M8 x 1.25   | 12mm         |      |      |
|   | 481-048      |             | 8mm          |      |      |
|   | 481-049      |             | 10mm         |      |      |
| Name  | Spaenaur No. | Key Length  | Qty.         | Page |      |
| Hex Key Alloy Steel DIN 911 Metric                      | 130-203      | 1.5mm       | 1            | P9   |      |
|   | 130-204      | 2.0mm       |              |      |      |
|   | 130-205      | 2.5mm       |              |      |      |
|   | 130-207      | 3.0mm       |              |      |      |
|   | 130-206      | 4.0mm       |              |      |      |

**ASSORTMENT** **805-490** **DIN 915**

**METRIC "REGULAR" (COARSE) THREAD HEX SOCKET SET SCREWS**

Grade 45H ALLOY STEEL Not Plated

**24 Sizes**  
**500 Pieces**

With **DOG POINT**

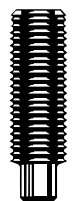

| Thread Size | Spaenaur No. | Screw Length | Qty. | Page |
|-------------|--------------|--------------|------|------|
| M3 x 0.50   | 481-136      | 4mm          | 40   | B252 |
|             | 481-138      | 6mm          |      |      |
|             | 481-139      | 8mm          |      |      |
|             | 481-140      | 10mm         |      |      |
|             | 481-141      | 12mm         |      |      |
| M4 x 0.70   | 481-142      | 5mm          | 30   |      |
|             | 481-144      | 8mm          |      |      |
|             | 481-146      | 12mm         |      |      |
|             | 481-147      | 16mm         |      |      |
| M5 x 0.80   | 481-148      | 6mm          | 20   |      |
|             | 481-150      | 10mm         |      |      |
|             | 481-152      | 16mm         |      |      |
|             | 481-153      | 20mm         |      |      |
| M6 x 1.00   | 481-154      | 6mm          | 15   |      |
|             | 481-156      | 10mm         |      |      |
|             | 481-158      | 16mm         |      |      |
|             | 481-159      | 20mm         |      |      |
|             | 481-160      | 25mm         |      |      |
|             | 481-161      | 8mm          |      |      |
| M8 x 1.25   | 481-163      | 12mm         | 10   |      |
|             | 481-165      | 20mm         |      |      |
|             | 481-167      | 30mm         |      |      |
|             | 481-169      | 12mm         |      |      |
| M10 x 1.50  | 481-170      | 16mm         | 5    |      |

REGULAR SIZE grey enamelled STEEL. Drawer has "Scooped" bins. Drawer fits Slide Racks shown on page A2  
Shipping weight: **2.49 kg** (5.5 lbs.)

**ASSORTMENT** **805-495** **DIN 479**

**METRIC "REGULAR" (COARSE) THREAD SQUARE HEAD SET SCREWS**

STEEL Property Class 8.8 Not Plated

**24 Sizes**  
**500 Pieces**

With **DOG SHORT POINT**



| Thread Size | Spaenaur No. | Screw Length | Qty. | Page |
|-------------|--------------|--------------|------|------|
| M5 x 0.80   | 487-028      | 8mm          | 40   | B253 |
|             | 487-003      | 16mm         |      |      |
|             | 487-005      | 25mm         |      |      |
|             | 487-006      | 30mm         |      |      |
|             | 487-007      | 35mm         |      |      |
| M6 x 1.00   | 487-010      | 12mm         | 30   |      |
|             | 487-B01-1C   | 16mm         |      |      |
|             | 487-012      | 20mm         |      |      |
|             | 487-013      | 25mm         | 20   |      |
|             | 487-014      | 30mm         |      |      |
| M8 x 1.25   | 487-016      | 40mm         | 15   |      |
|             | 487-019      | 12mm         |      |      |
|             | 487-020      | 16mm         |      |      |
|             | 487-021      | 20mm         |      |      |
|             | 487-022      | 25mm         |      |      |
|             | 487-023      | 30mm         | 10   |      |
|             | 487-024      | 35mm         |      |      |
|             | 487-032      | 20mm         |      |      |
|             | 487-034      | 30mm         |      |      |
|             | 487-036      | 40mm         |      |      |
| M10 x 1.50  | 487-041      | 25mm         | 5    |      |
|             | 487-042      | 35mm         |      |      |
| M12 x 1.75  | 487-046      | 40mm         | 5    |      |

REGULAR SIZE grey enamelled STEEL. Drawer has "Scooped" bins. Drawer fits Slide Racks shown on page A2  
Shipping weight: **5.60 kg** (12.25 lbs.)