

2-Point Rod Actuated

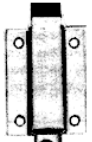

099-247

(Zinc Plated)
Rod Actuated
Key-Locking
(Shown)
Keyed to differ
with one key

Weight
3 lbs. 1 oz. each

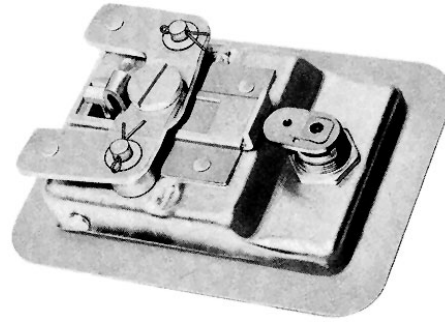

Rear View

This smooth-acting, slam-type latch is intended for use on all types of compartment doors on farm equipment enclosures, stationary equipment, and machine tool cabinets.

The recessed pan permits flush installation; simply cut an appropriate hole and attach by screws, bolts, or welding. This latch is especially suited for installation in tight quarters because the overall thickness is only 1-9/16".

SPAENAUR No.	Description	Mfr. #
099-247	Rod Control Lock, Key-Locking, Keyed to differ	4972-X
099-246	Ditto, but Non-Locking	4973-X
099-024	Key Cylinder only, Keyed to differ, with one key	4901-51

099-246

(Zinc Finish)
Rod Actuated
Non Key-Locking
Rods furnished for
maximum overall
length of lock
assembly of
68-7/8".

Weight
2 lbs. 13 oz. each

End-latching slide
bolts are equipped
with Stainless Steel
Springs

NOTE: FURNISHED WITHOUT HOLE IN ROD ON ONE END. CUSTOMER WILL CUT ROD TO DESIRED LENGTH & DRILL 1/16" DIA. HOLE.

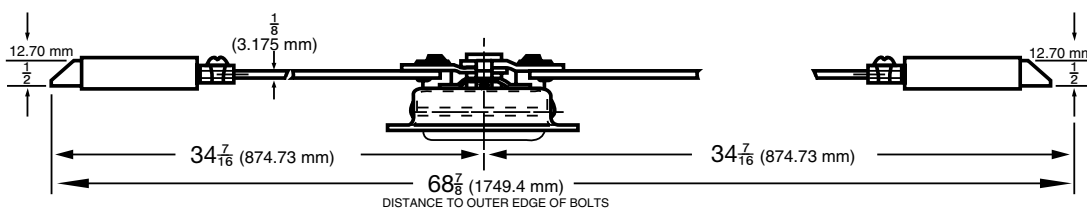
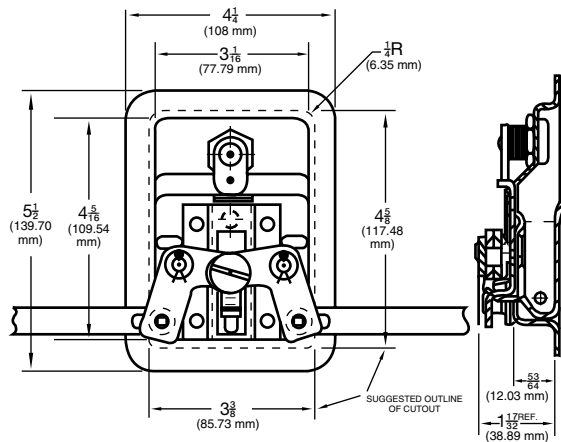
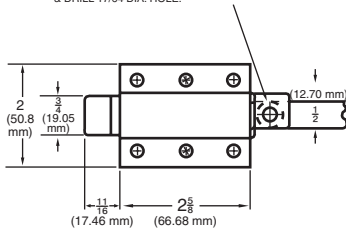

CATALOG 13