

Light Duty Shelf Supports

Light Duty Shelf Supports are designed to accommodate light to medium shelf loads. Manufactured from Clear Butyrate, these supports are durable yet attractive, and can be used in a wide range of shelf configurations.

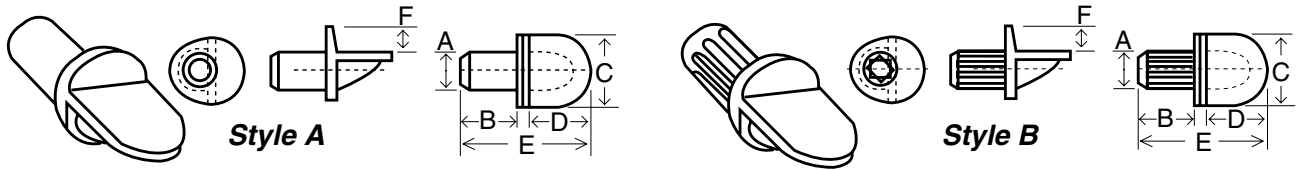

SPAENAUR No.	Style	A	B	Dimensions			E	F	Unit Pkg. Quantity
699-404	A	.234"	13/32"	1/2"	29/64"	29/32"	3/16"	100	
699-405	A	.234"	11/32"	1/2"	29/64"	27/32"	3/16"	100	
699-406	A	.232"	.370"	1/2"	29/64"	7/8"	3/16"	100	
699-407	B	.250"	13/32"	1/2"	29/64"	29/32"	1/4"	100	
699-408	B	.250"	1/4"	1/2"	29/64"	3/4"	3/16"	100	
699-409	A	.255"	13/32"	1/2"	15/32"	59/64"	3/16"	100	

Heavy Duty Shelf Supports

Heavy Duty Shelf Supports are manufactured from durable Styrene and are designed for heavy loads and will provide years of economical and attractive support. Available in beige colour only.

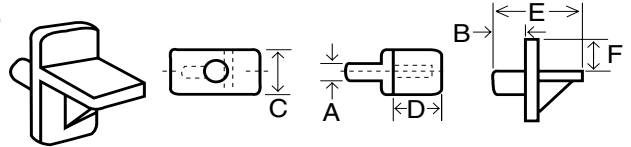

SPAENAUR No.	A	B	Dimensions			F	Unit Pkg. Quantity
699-401	.234"	7/16"	1/2"	35/64"	1-1/16"	5/16"	100
699-402	.234"	1/4"	1/2"	35/64"	7/8"	5/16"	100

Glass Shelf Supports

Glass Shelf Supports clamp on easily to metal brackets. Manufactured from Butyrate, Shelf Supports are glass like in appearance, as well as extremely stress and impact resistant.

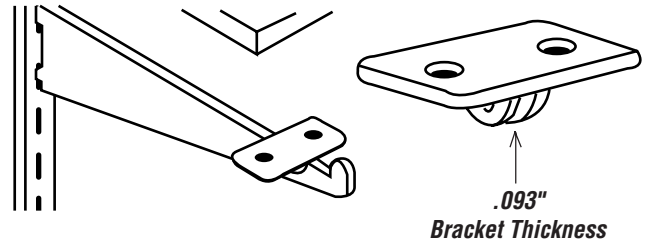

Unit Pkg. Qty.
50

SPAENAUR No. **699-410**

P.C. 086

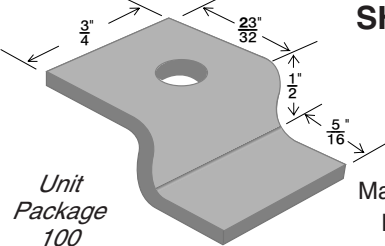

SHELF SUPPORT CLIP

Steel-Zinc Plated

C-792

Style: 1/2" Offset

Material Thickness: 1/16" (.062")

Hole Diameter: 7/32" (.219")

Unit Package
100

CATALOG 13