

**C SECTION Assortments**

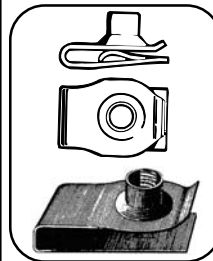

**805-512**  
*Spring Steel - Heat Treated*  
**EXTRUDED PANEL NUTS  
 & U-TYPE SPRING NUTS**  
 For Automotive Service and Industrial use  
 7 Extruded Panel Nuts  
 17 U-Type Spring Nuts  
 Total Pieces - 650  
 Regular Box  
 Inch Sizes See page C139

**805-665**

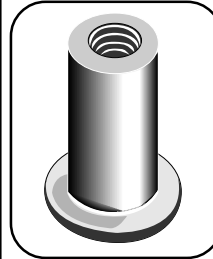

**805-544**  
*Neoprene*  
**WELL NUT™  
 SCREW ANCHORS**  
 16 Sizes - 140 Pieces  
 Regular Box  
 Inch Sizes See page C147



**805-647**  
*Carbon Steel, Plated*  
**RED HEAD®  
 SLEEVE ANCHORS**  
 Assorted Head Styles  
 26 Sizes - 120 Pieces  
 Large Box  
 Inch Sizes See page C158



**805-663**  
*Steel, Plated*  
**AVK INDUSTRIAL PRODUCTS  
 A-K™ SERIES INSERTS**  
 16 Sizes - 331 Pieces including  
 insert tool TAA170.  
 Large Box  
 Inch Sizes See page C170



**805-664**  
*Steel, Plated*  
**AVK INDUSTRIAL PRODUCTS  
 A-L™ SERIES INSERTS**  
 16 Sizes - 331 Pieces including  
 insert tool TAA170.  
 Large Box  
 Inch Sizes See page C170

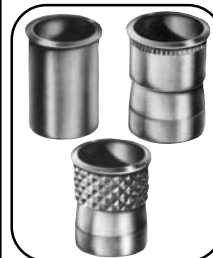

**805-665**  
*Steel, Plated*  
**AVK A-O, A-T &  
 A-W SERIES INSERTS**  
 20 Sizes - 390 Pieces also contains 8  
 Conversion Kits and insert tool TAA170.  
 Large Box  
 Inch Sizes See page C175



**805-492**  
*Steel with Finish*  
**ON-SERT® FASTENER**  
 Ideal for Prototype Work  
 12 Sizes - 800 Pieces  
 Regular Box  
 Inch Sizes See page C198

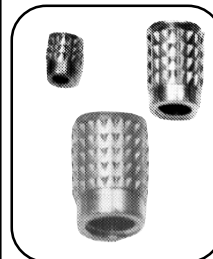

**805-493**  
*Brass*  
**BARB-SERT BRASS INSERTS**  
 Ideal for Prototype Work  
 25 Sizes - 480 Pieces  
 Regular Box  
 Inch and Metric Sizes See page C202



**805-425**  
*Steel, Black Oxide*  
**"E-Z LOK" THREAD INSERTS**  
 Coarse and Fine Thread  
 21 Sizes - 60 Pieces  
 Regular Box  
 Inch Sizes See page C215



**805-422**  
*Steel, Black Oxide*  
**"E-Z LOK" THREAD INSERTS**  
 15 Sizes - 60 Pieces  
 Regular Box  
 Metric Sizes See page C215



**805-423**  
*303 Stainless Steel*  
**"E-Z LOK" THREAD INSERTS**  
 12 Sizes - 42 Pieces  
 Regular Box  
 Inch Sizes See page C215

**C SECTION Assortments**

CATALOG 13