

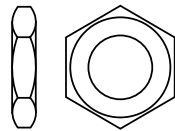

**DIN 929**  
Hexagon Weld Nuts  
Écrous à souder  
pg. C52



**DIN 936**  
Hexagon Low Nuts  
Écrous hexagonaux  
pg. C15



**DIN 963**  
Machine Screws  
Slot Drive – Flat Head  
Vis de mécanique  
à tête fendue  
pg. B40 ~ISO 2009



**DIN 980**  
Prevailing Torque  
Hex Locknuts  
Écrous indesserrables  
pg. C36 ~ISO 7042

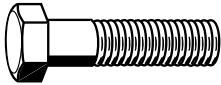

**DIN 931**  
Hexagon Cap Screws –  
Partially threaded - Unslotted  
Boulons de précision  
hexagonaux  
pg. B194 ~ISO 4014

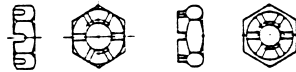

**DIN 937**  
Thin Slotted and Castellated  
Hexagon Nuts  
Écrous hexagonaux à  
créneaux  
pg. C18



**DIN 964**  
Machine Screws  
Slot Drive – Oval Head  
Vis de mécanique  
à tête fendue  
pg. B41 ~ISO 2010

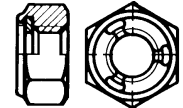

**DIN 980M**  
Spring-Stop Hex Locknuts  
Écrous auto-freines  
hexagonaux  
pg. C36

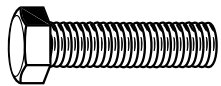

**DIN 933**  
Hexagon Cap Screws - Fully  
threaded – Unslotted  
Boulons de précision  
hexagonaux  
pg. B190 ~ISO 4017



**DIN 938**  
Studs  
Goujons  
pg. B347



**DIN 965**  
Machine Screws - Phillips  
Drive - Flat Head / Vis  
mécanique à tête Phillips  
pg. B65 ~ISO 7046



**DIN 980V**  
Prevailing Torque  
Hex Locknuts  
Écrous indesserrables  
pg. C36



**DIN 934**  
Hexagon Nuts  
Écrous hexagonaux  
pg. C9 ~ISO 4032/8673



**DIN 939**  
Studs  
Goujons  
pg. B347



**DIN 966**  
Machine Screws - Phillips  
Drive – Oval Head / Vis  
mécanique à tête Phillips  
pg. B65 ~ISO 7047

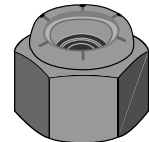

**DIN 982**  
Heavy Nylon Insert  
Hex Locknut  
Écrous à garniture en nylon  
pg. C35

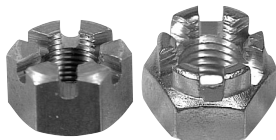

**DIN 935**  
Slotted and Castellated  
Hexagon Nuts  
Écrous hexagonaux à créneaux  
pg. C17 ~ISO 7035/7036/7037

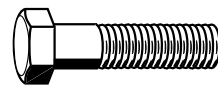

**DIN 960**  
Hexagon Cap Screws –  
Partially Threaded  
Boulons de précision  
hexagonaux  
pg. B200 ~ISO 8765



**DIN 975**  
Threaded Rod  
Tiges filetées  
pg. B344

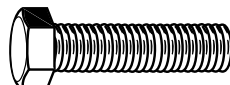

**DIN 961**  
Hexagon Cap Screws -  
Fully Threaded  
Boulons de précision  
hexagonaux  
pg. B198 ~ISO 8675



**DIN 976B**  
Threaded Pins  
Tiges filetées  
pg. B347



**DIN 985**  
Nylon Insert Hex Locknuts  
Écrous à garniture en nylon  
pg. C33 ~ISO 7040